



Pentures, serrures
et pièces de fixation
Locks and patch fittings

 **KRAUS**
www.kraussro.sk
info@kraussro.sk :: +421 2 2092 0888

ASSA ABLOY

Pentures,
serrures et
pièces de fixation
*Locks and
patch fittings*

Cilindric®

Caractéristiques techniques

- Dimensions \varnothing 55 mm hauteur 75 mm
- Inox AISI 304
- Pour verre de 8, 10 et 12 mm
- Montage sur encoche
- Poids maximum 100 kg

Technical features

- Dimensions \varnothing 55 mm height 75 mm
- Stainless steel 304
- For 8, 10 and 12 mm thick glass
- Assembly on notch
- Maximum door weight 100 kg

C500D

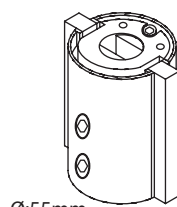

\varnothing :55mm
height:75mm

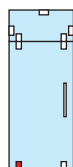
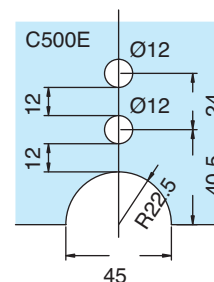

Références / References



Penture basse empreinte pour axe allemand
Bottom patch fitting German insert



Inox Brossé
Brushed stainless steel

C500D.15

LES + PRODUITS

The + product

Design High Tech

Grande qualité de finition

Résistance

Modularité

Inox massif

High tech design

High quality finishes

Resistance

Modularity

Solid stainless Steel

C500I

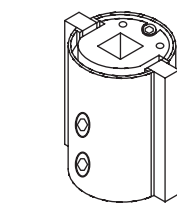

\varnothing :55mm
height:75mm

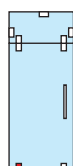
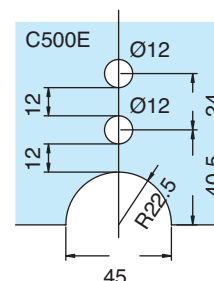

Références / References



Penture basse empreinte pour insert italien
Bottom patch fitting Italian insert



Inox Brossé
Brushed stainless steel

C500I.15

C501

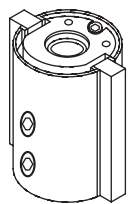

Ø:55mm
height:75mm

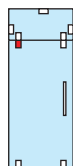
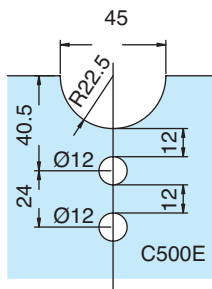

Références / References



Penture haute
Top patch fitting



Inox Brossé
Brushed stainless steel

C501.15

KRAUS
www.kraussro.sk
info@kraussro.sk :: +421 2 2092 0888

www.kraussro.sk

info@kraussro.sk :: +421 2 2092 0888

C502

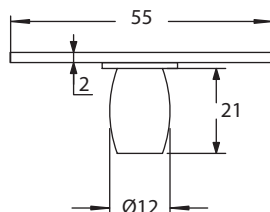

Inox Brossé
Brushed stainless steel

C502.15

Références / References

Pivot haut, fixation linteau ou plafond
Top pivot, fixing lintel or ceiling

C511

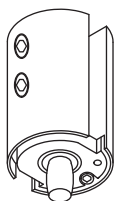

Ø:55mm
height:75mm

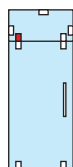
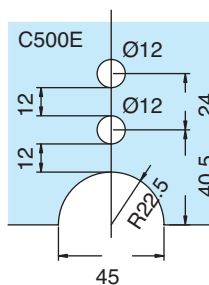

Références / References



Contre-sabot d'imposte avec pivot
Transom panel patch with pivot



Inox Brossé
Brushed stainless steel

C511.15

AC299.33

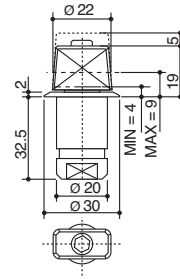

Crapaudine à sceller réglable axe rectangulaire allemand
Adjustable German rectangular floor pivot, to be embedded



AC246.33

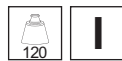
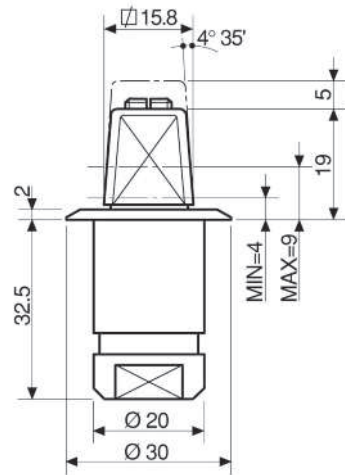

Crapaudine à sceller réglable axe carré italien
Adjustable Italian square floor pivot, to be embedded

V502

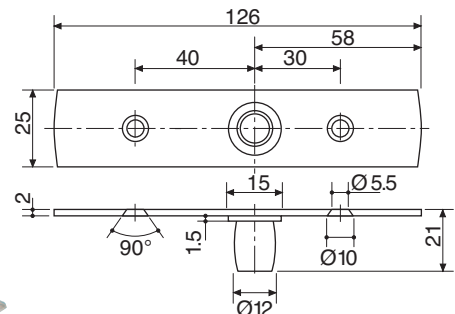
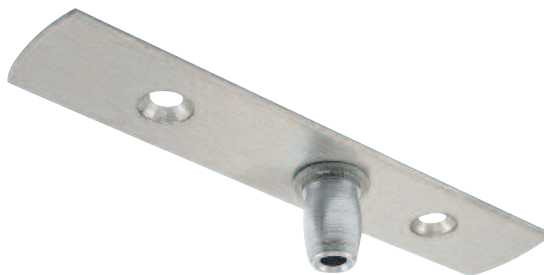

Références / References

Pivot supérieur pour V501/V201
Offset top pivot for V501/V201

Inox Brossé
Stainless steel effect

V502.15

C528A

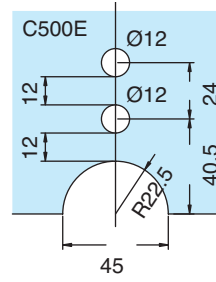
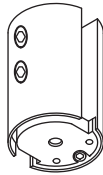

Inox Brossé
Brushed stainless steel

Références / References



Ø:55mm
height:75mm

C528A.15

Pièce de fixation pour panneaux fixe
Wall to glass patch for transom or fixed panel

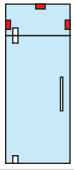

C528B

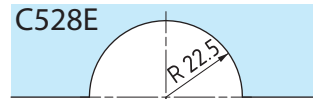
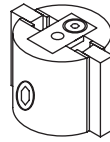
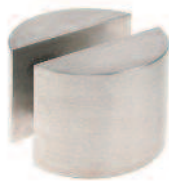

Inox Brossé
Brushed stainless steel

Références / References



Ø:55mm
height:35mm

C528B.15

Cilindric pièce de fixation pour panneaux fixe hauteur 35 mm
Cilindric wall to glass patch for transom or fixed panel height 35mm

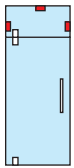

C581

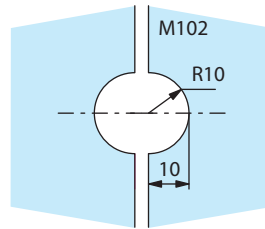
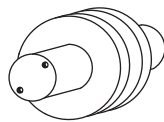

Inox Brossé
Brushed stainless steel

Références / References



C581.15

Pièce de liaison pour 2 glaces fixes modèle rond / simple
Connector for 2 fixed panels single rounded model

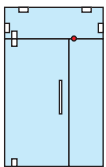

C582

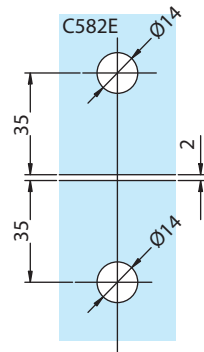
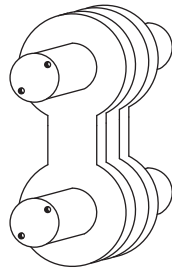

Inox Brossé
Brushed stainless steel

Références / References



C582.15

Pièce de liaison pour 2 glaces fixes modèle '8'
Connector for 2 fixed panels '8' shape

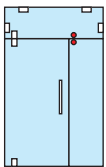

C583

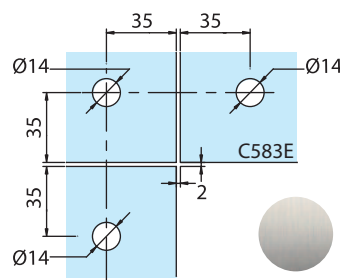
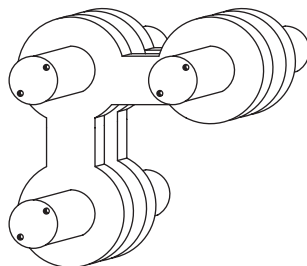

Inox Brossé
Brushed stainless steel

Références / References



C583.15

Pièce de liaison pour 3 glaces fixes
Connector for 3 fixed panels

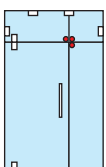

C222L

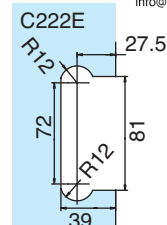
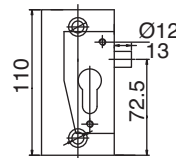
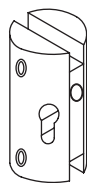

Inox Brossé
Brushed stainless steel

C222L.15

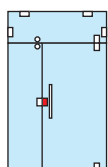

Références / References



Serrure bord de verre gauche extérieur, sans cylindre et sans gâche
Lock on left outside edge of glass, supplied without cylinder and flat keep



C222R

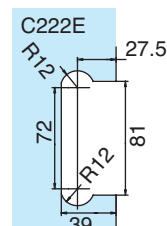
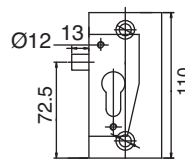
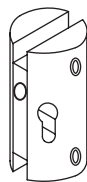

Inox Brossé
Brushed stainless steel

C222R.15

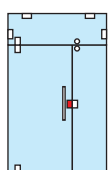

Références / References



Serrure bord de verre droite extérieur, sans cylindre et sans gâche
Lock on right outside edge of glass, supplied without cylinder and flat keep

C223L

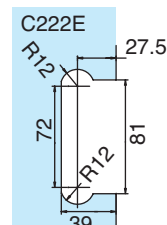
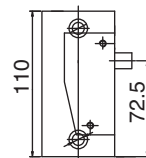
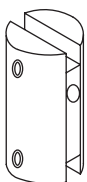

Inox Brossé
Brushed stainless steel

C223L.15

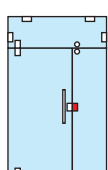

Références / References



Contre-boîtier pour serrure, bord de verre gauche extérieur
Patch keep on left side edge of fixed panel

C223R

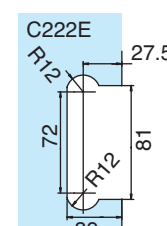
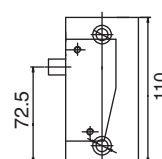
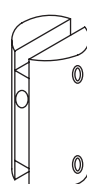

Inox Brossé
Brushed stainless steel

C223R.15

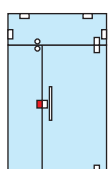

Références / References



Contre-boîtier pour serrure, bord de verre droit extérieur
Patch keep on right side edge of fixed panel

C517

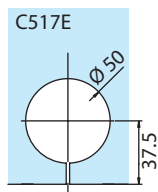
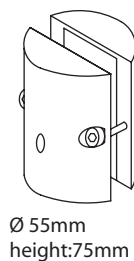

Références / References



Serrure à clé sans gâche
Lock with key without flat keep



Inox Brossé
Brushed stainless steel

C517.15

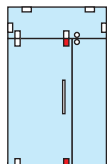

C529

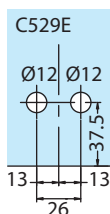
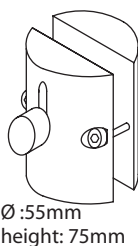

Références / References



Serrure à pieds sans gâche
Foot operated lock without flat keep



Inox Brossé
Brushed stainless steel

C529.15

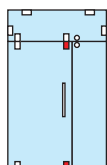

Poignées
Handles

C600PG22

C600PG30

C601PG22

C601PG30

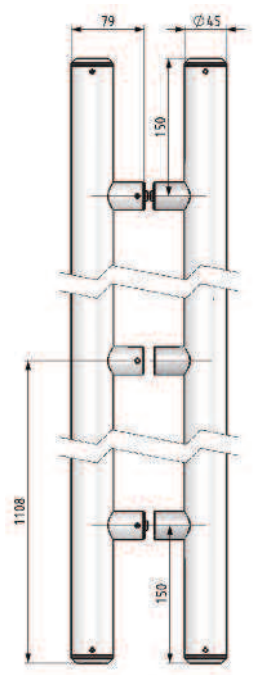
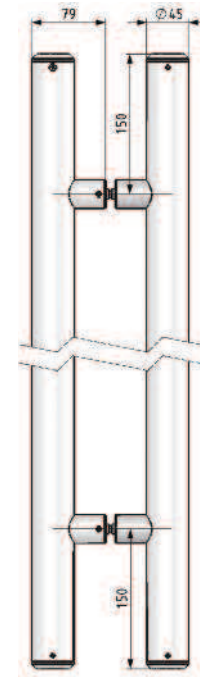
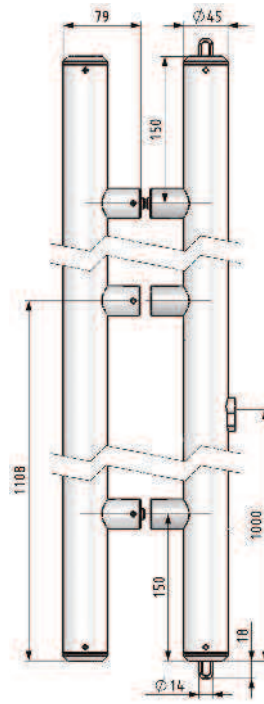
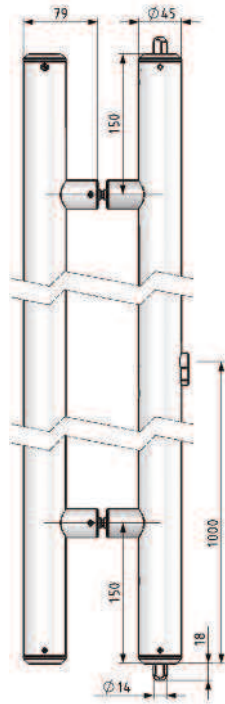

Références / References



Inox Brossé
Brushed stainless steel

Poignées Ø 45 mm, avec serrure 2 points d'un côté, hauteur maxi : 2200 mm
Handle 45 Ø mm with 2 point lock on one side, height max : 2200 mm

C600PG22.15

Poignées Ø 45 mm, avec serrure 2 points d'un côté, hauteur entre 2200 mm et 3000 mm maxi
Handle 45 Ø mm with 2 point lock on one side, height max between 2200 mm and 3000 mm

C600PG30.15

Poignées Ø 45 mm, hauteur maxi : 2200 mm
Handle 45 Ø mm height max 2200 mm

C601PG22.15

Poignées Ø 45 mm, hauteur entre 2200 mm et 3000 mm maxi
Handle 45 Ø mm, height max between 2200 mm and 3000 mm

C601PG30.15

LES + PRODUITS

The + product

Esthétique

Double fonction :
tirage et verrouillage

Robustesse

Porte grande
hauteur

Attractive design

Double fonction :
pull and lock

Resistant

For high doors

KRAUS
www.kraussro.sk
info@kraussro.sk :: +421 2 2092 0888



C532



Références / References

Gâche pour poignée C600
Keep plate for C600



Inox Brossé
Brushed stainless steel

C532.15

KRAUS
www.kraussro.sk
info@kraussro.sk :: +421 2 2092 0888

Poignées
Handles

C541

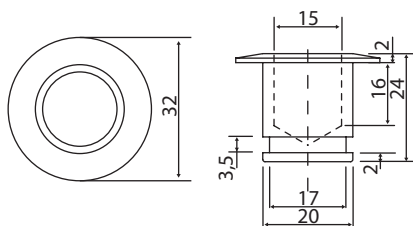

Références / References

Gâche tubulaire pour pêne bas des C600-C517-C529
Tubular keep bottom bolt for C600-C517-C529



Inox Brossé
Brushed stainless steel

C541.15

C603PG

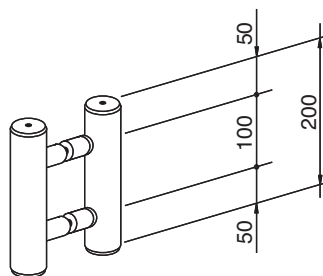

Références / References



Contre-boîtier d'imposte pour C600
Transom patch keep for C600



Inox Brossé
Brushed stainless steel

C603PG.15

Caractéristiques techniques

- Pour verre trempé de 10 mm
- Montage sur encoche 101
- Poids de porte maximum 50 kg
- Dimensions maxi des portes 900 x 2200 mm
- Réversible droite, gauche, haute ou basse pour les séries 3271 et 3275
- Réversible droite, gauche pour les séries 3272 et 3273
- Livré avec joints épaisseur 1 mm
- Pentures basses compatibles avec :
 - Pivot frein de sol hydraulique
 - Crapaudine

Technical features

- For 10 mm thick toughened glass
- Assembly on notch 101
- Maximum door weight 50 kg
- Dimensions size of the doors 900 x 2200 mm
- Top or bottom hinge reversible left or right for series 3271 and 3275
- Left or right hinge reversible for series 3271 and 3275
- Supplied with spacers of 1 mm thick
- Bottom hinge compatible with :
 - Hydraulic floor sprin
 - Pivot



LES + PRODUITS

The + product

Réversible
droite, gauche,
haute ou basse
pour 3271 / 3275

Top or bottom hinge
reversible left or right
for 3271 and 3275

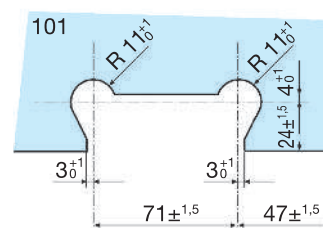
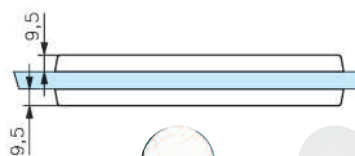
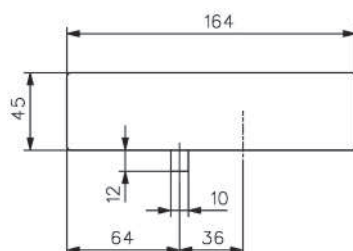

Références / References

3271



Chromé brillant
Bright chromium

Chromé mat
Matt chromium

Doré
Gold plated

Laqué blanc 9010
Lacquered white RAL 9010

Penture réversible haute, basse à enjoliveurs pour axe carré français
Top and bottom reversible patch hinge with cover plate, French square recess

3271.30.0

3271.31.0

3271.40.0

3271.51.0

3272

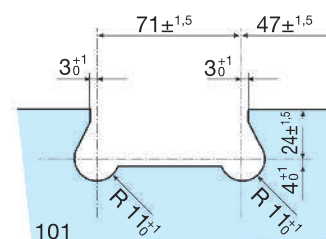
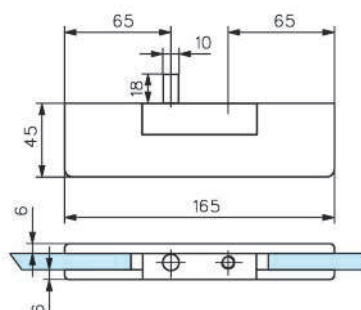
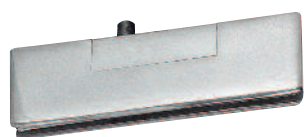

Références / References



Laiton poli
Polished brass



Chromé brillant
Bright chromium



Chromé mat
Matt chromium

Penture massive haute
Solid top patch hinge

3272.00.0

3272.30.0

3272.31.0

3273

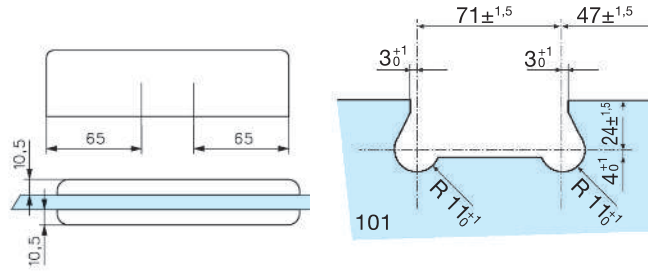

Pentures,
serrures et
pièces de fixation
Locks and
patch fittings

Références / References



Laiton poli
Polished brass



Chromé brillant
Bright chromium



Chromé mat
Matt chromium

Penture massive basse pour axe carré français
Solid bottom patch hinge with French square recess

3273.00.0

3273.30.0

3273.31.0

KRAUS
www.kraussro.sk
info@kraussro.sk :: +421 2 2092 0888

3280

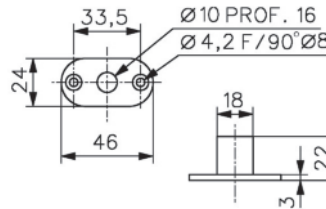

Laiton poli
Polished brass



Chromé brillant
Bright chromium



Chromé mat
Matt chromium

Références / References

Boîte à roulement pour pentures séries 3271, 3272
Bearing box for patch hinges series 3271, 3272

3280.00.0

3280.30.0

3280.31.0

3281

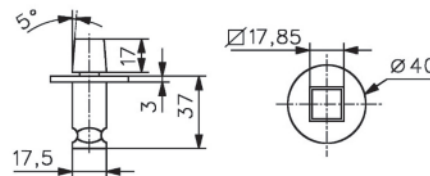

Laiton poli
Polished brass



Chromé brillant
Bright chromium



Chromé mat
Matt chromium

Références / References



Crapaudine à axe carré pour pentures séries 3271 et 3273
Square pin step bearing for patch hinges series 3271 and 3273

3281.00.0

3281.30.0

3281.31.0

Serrures basses , boîtier gâche et gâche séries 1358

Bottom lock, matching patch keep
and keep with guard series 1358

Caractéristiques techniques

- Pour verre trempé de 10 mm
- Montage sur encoche 61
- Pêne monobloc avec bague anti-sciage
- A cylindre profil européen panneton DIN (norme DIN 18254)
- Livré avec 1 gâche plate et 3 clés

Technical features

- For 10 mm thick toughened glass
- Assembly on notch 61
- One piece bolt with hardened insert
- European profile cylinder (DIN 18254)
- Supplied with flat keep and 3 keys



1358

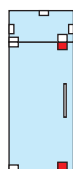
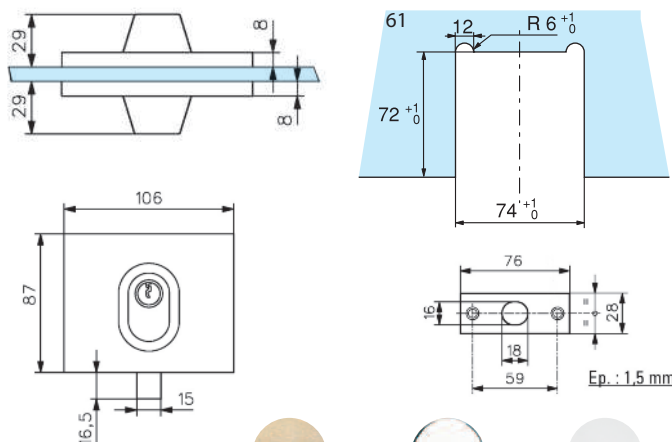

Références / References



Serrure basse avec cylindre à 2 entrées de clé
Bottom lock with euro profile cylinder with 2 key entries

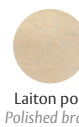

Laiton poli
Polished brass



Chromé brillant
Bright chromium



Chromé mat
Matt chromium

1358.00.0

1358.30.0

1358.31.0

1352

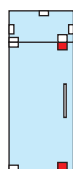
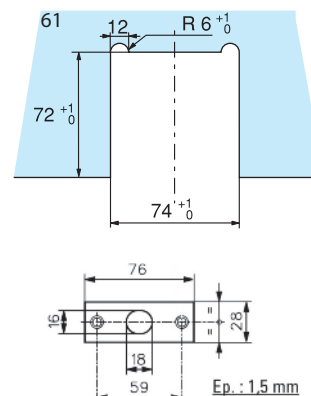
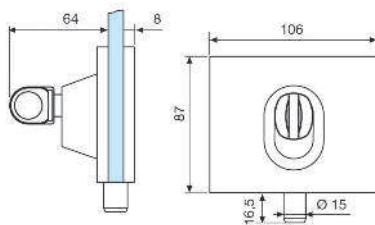

Références / References



Serrure basse à bouton d'un seul côté
Bottom lock with knob on one side



Chromé brillant
Bright chromium



Chromé mat
Matt chromium

1352.30.0

1352.31.0

1353

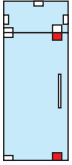
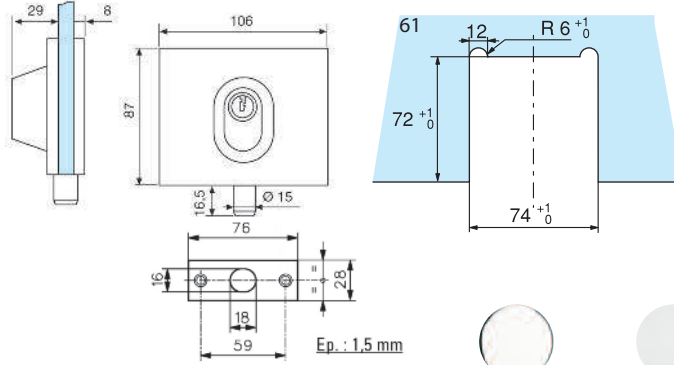

Références / References



Serrure basse à une entrée de clé
Bottom lock with key on one side



Chromé brillant
Bright chromium



Chromé mat
Matt chromium

1353.30.0

1353.31.0

KRAUS
www.kraussro.sk
info@kraussro.sk :: +421 2 2092 0888

Pentures,
serrures et
pièces de fixation
Locks and
patch fittings

1359

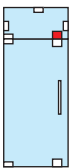
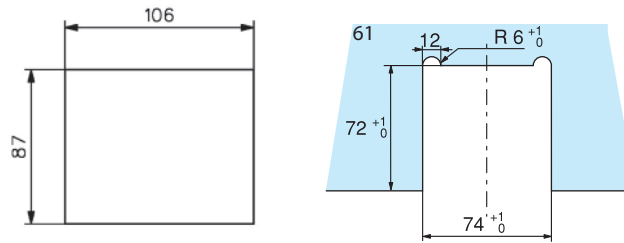

Références / References



Boîtier gâche pour serrures 1352, 1353, 1357 et 1358
Matching patch keep for lock 1352, 1353, 1357 and 1358

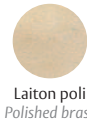

Laiton poli
Polished brass



Chromé brillant
Bright chromium



Chromé mat
Matt chromium

1359.00.0

1359.30.0

1359.31.0

9954

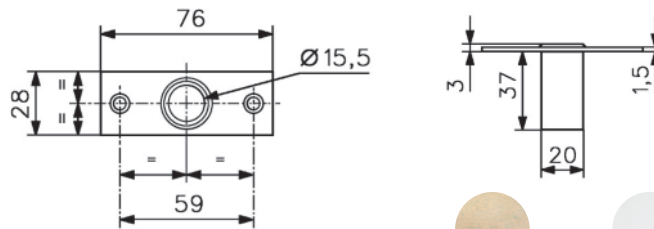

Références / References

Gâche anti-poussière à obturateur avec platine à 2 trous de fixation,
pour serrures série 1358
Keep with anti-dust guard, two fixing holes for locks series 1358

9954.00.0

9954.31.0

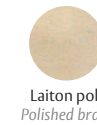

Laiton poli
Polished brass



Chromé mat
Matt chromium

9954.**.3

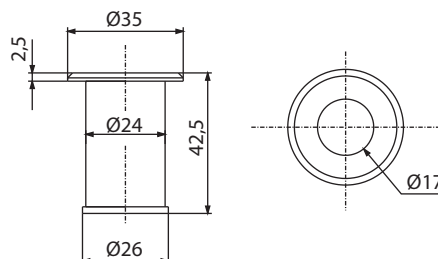

Références / References

Gâche anti-poussière à obturateur avec platine cylindrique à visser
pour serrures série 1358
Keep with anti-dust guard for locks series 1358

9954.00.3

9954.31.3

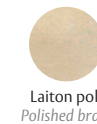

Laiton poli
Polished brass



Chromé mat
Matt chromium

Verrou cavalier à demi-cylindre 1435

Clip on lock with half euro profile cylinder 1435

Caractéristiques techniques

- Montage sans encoche
- Se pose en cavalier sur la porte, jeu minimum 4 mm
- Fixation par 2 vis de serrage pour 1435 et 1439
- Permet d'obtenir un 2ème point de condamnation avec une serrure basse série 1358
- Possibilités de combinaison avec passe général sauf 1436
- Livré avec 1 gâche plate et 3 clés

Technical features

- No notches required
- Fixing on edge of door, minimum space 4 mm
- Fixing with 2 screws for series 1435 and 1439
- To match bottom lock series 1358 to provide 2 locking points
- Possibility of combinations with master key except 1436
- Supplied with flat keep and 3 keys



1435

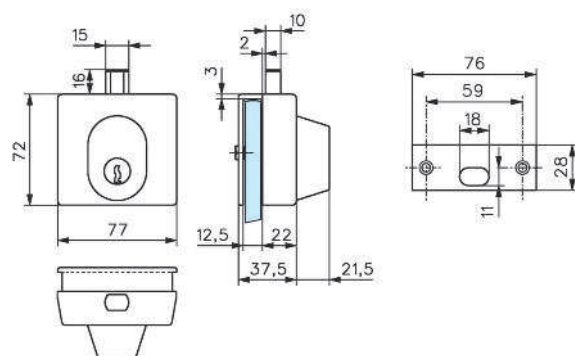

Références / References



Verrou cavalier à demi-cylindre profil européen panneton DIN
Clip on lock with half euro profile cylinder



Chromé brillant
Bright chromium



Chromé mat
Matt chromium



Doré
Gold plated

1435.30.0

1435.31.0

1435.40.0

1439

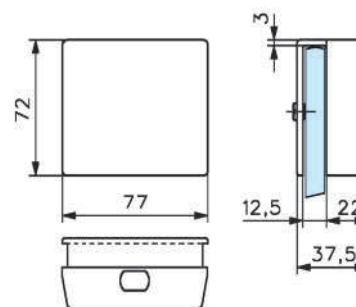

Références / References



Boîtier gâche pour verrou cavalier 1435
Matching patch keep to fit with series 1435



Chromé brillant
Bright chromium



Chromé mat
Matt chromium



Doré
Gold plated

1439.30.0

1439.31.0

1439.40.0

Pentures,
serrures et
pièces de fixation
*Locks and
patch fittings*

KRAUS
www.kraussro.sk
info@kraussro.sk :: +421 2 2092 0888



S171.**.3

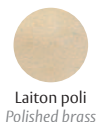

Laiton poli
Polished brass



Inox Brossé
Brushed stainless steel

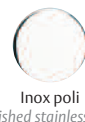

Inox poli
Polished stainless steel

100 vis pour pentures séries 3272 et 3273
100 screws for patch hinge series 3272 and 3273

S171.00.3

S171.15.3

S171.16.3

S229.99.4



100 joints épaisseur 1mm pour pentures séries 3272 et 3273
100 spacers 1 mm thickness for patch hinge series 3272 and 3273

S229.99.6



100 joints épaisseur 1,5 mm pour pentures séries 3271 et 3275
100 spacers 1,5 mm thickness for patch hinge series 3271 and 3275

Pentures,
serrures et
pièces de fixation
*Patch fittings
and locks*

PF Patch fittings

Caractéristiques techniques

- Pour verre épaisseur 10 et 12 mm
- Poids maximum 80 kg
- Dimensions maxi. des portes 1100 x 2400 mm

Technical features

- For 10 and 12 mm thick glass
- Maximum Door Weight 80 kg
- Maximum Door Width 1100 x 2400 mm



LES + PRODUITS

The + product

Grande qualité
de finition

Gamme complète

Réversibles

High quality finishes

Full range

Reversible

Installation standard

Standard installation

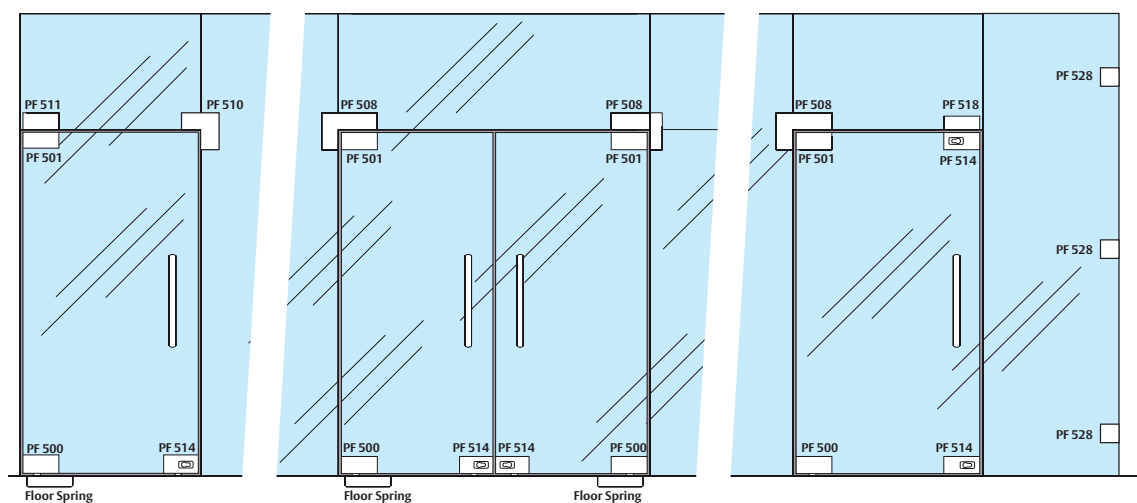
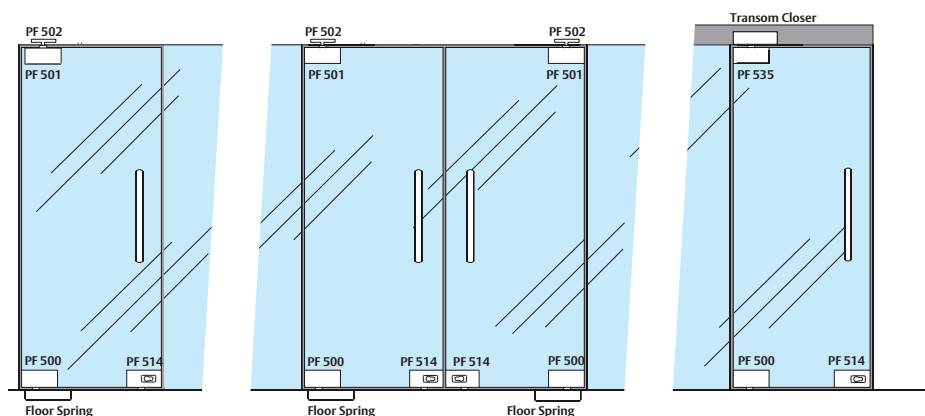

JEUX RECOMMANDÉS

RECOMMENDED TOLERANCES

Pentures,
serrures et
pièces de fixation
*Patch fittings
and locks*

 **KRAUS**
www.kraussro.sk
info@kraussro.sk :: +421 2 2092 0888

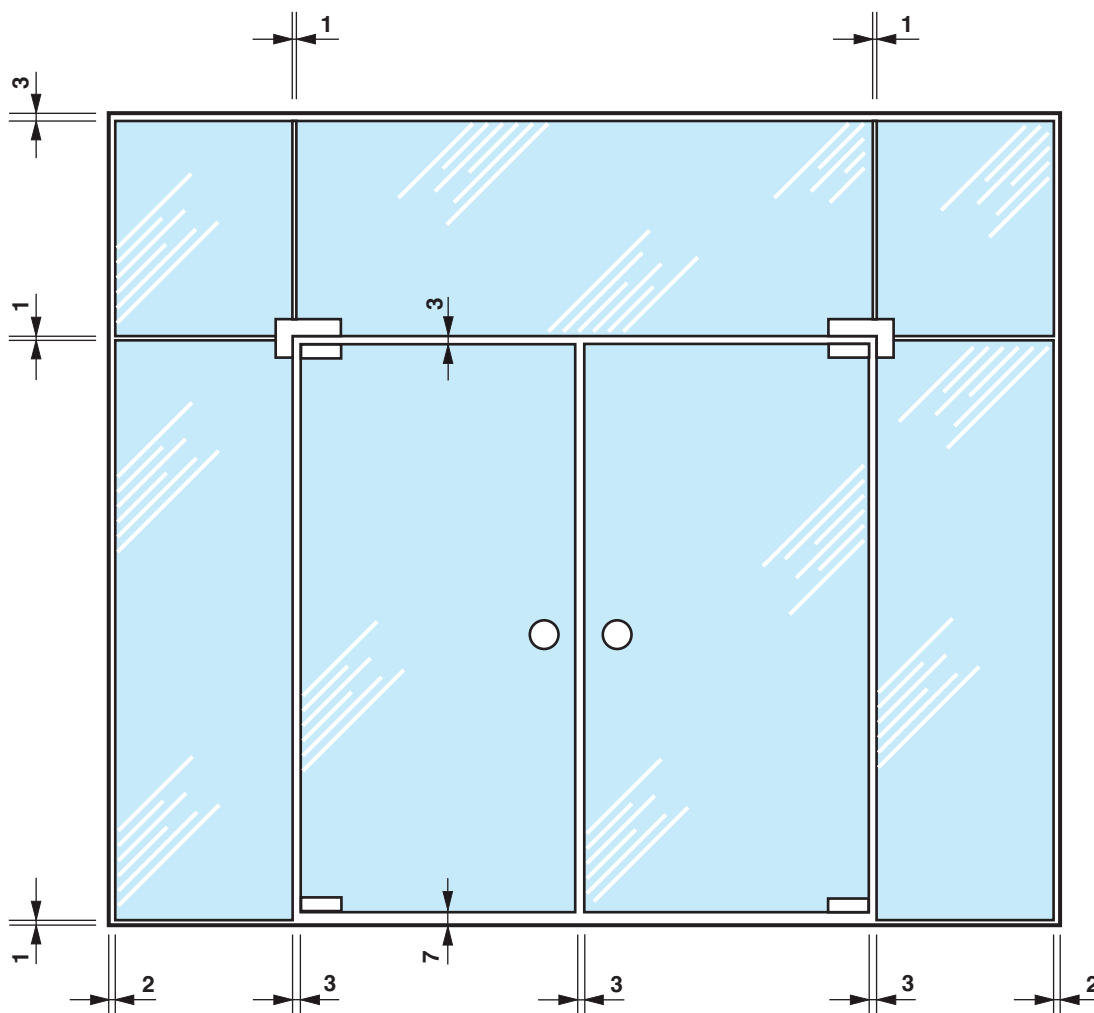

Pentures,
serrures et
pièces de fixation
*Patch fittings
and locks*

PF500

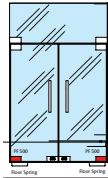
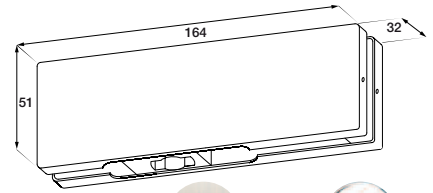
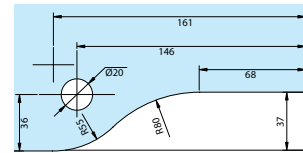

Références / References



Bottom Patch fitting for German Spindle
Bottom Patch fitting for German Spindle



PF500.15

PF500.16



LES + PRODUITS

The + product

Grande qualité
de finition

Gamme complète

Réversibles

High quality finishes

Full range

Reversible

PF501

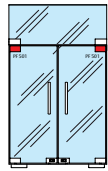
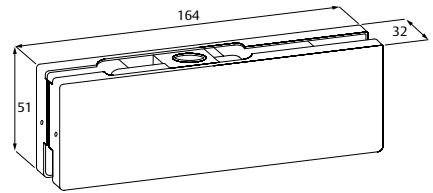
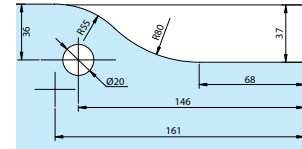

Références / References

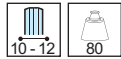

Top Patch fitting to suit 15 mm pivot.
Top Patch fitting to suit 15 mm pivot.



PF501.15

PF501.16

KRAUS
www.kraussro.sk
info@kraussro.sk :: +421 2 2092 0888

PF535

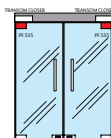
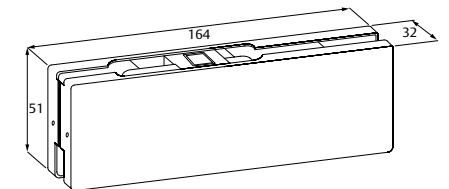
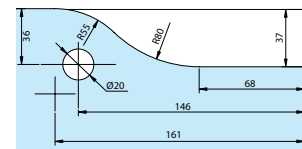
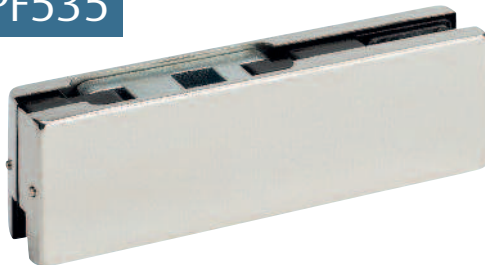

Références / References

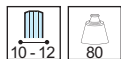

Top Patch fitting for Transom Closer (side load).
Top Patch fitting for Transom Closer (side load).



PF535.15

PF535.16

PF502



Pentures,
serrures et
pièces de fixation
*Patch fittings
and locks*

Références / References

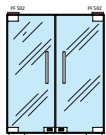

Top pivot 15 mm
Top pivot 15 mm



Inox Brossé
Brushed stainless steel

PF502 .15

KRAUS
www.kraussro.sk
info@kraussro.sk :: +421 2 2092 0888

AC299.33

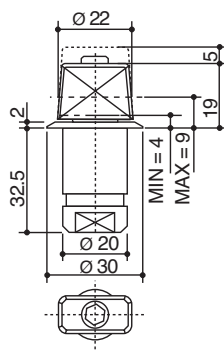

Références / References

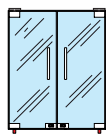

Adjustable German rectangular free swing floor pivot
Adjustable German rectangular free swing floor pivot

Pentures,
serrures et
pièces de fixation
*Patch fittings
and locks*

PF511

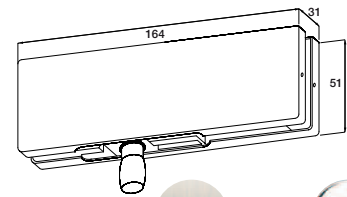
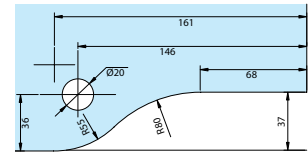

Inox Brossé
Brushed stainless steel



Inox poli
Polished stainless steel

PF511.15

PF511.16

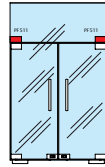

Références / References

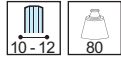

Top Patch with 15 mm pivot
Top Patch with 15 mm pivot



LES + PRODUITS

The + product

Grande qualité
de finition

Gamme complète

Réversibles

High quality finishes

Full range

Reversible

PF508

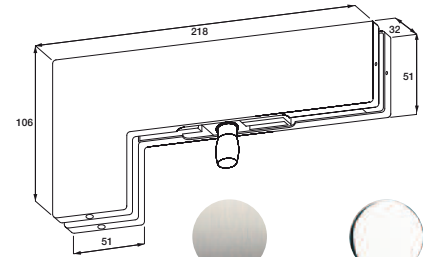
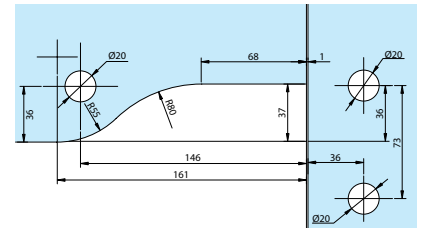

Inox Brossé
Brushed stainless steel



Inox poli
Polished stainless steel

PF508.15

PF508.16

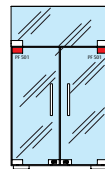

Références / References

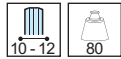

Transom and side panel link patch
Transom and side panel link patch

KRAUS
www.kraussro.sk
info@kraussro.sk :: +421 2 2092 0888

PF510

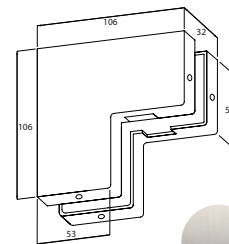
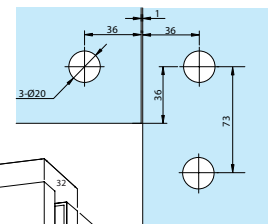

Inox Brossé
Brushed stainless steel



Inox poli
Polished stainless steel

PF510.15

PF510.16

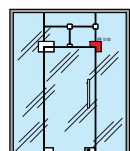

Références / References

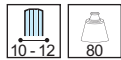

Transom and side panel link patch
Transom and side panel link patch

Pentures,
serrures et
pièces de fixation
*Patch fittings
and locks*

KRAUS
www.kraussro.sk
info@kraussro.sk :: +421 2 2092 0888

PF514

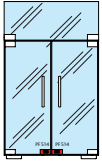
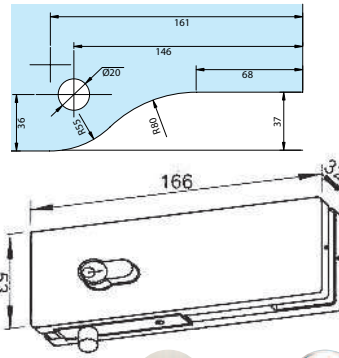

Références / References



Corner Lock for Europrofile Cylinder
Corner Lock for Europrofile Cylinder



Inox Brossé
Brushed stainless steel

PF514.15



Inox poli
Polished stainless steel

PF514.16

PF518

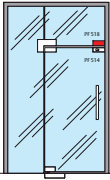
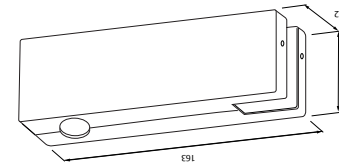
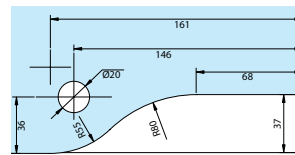

Références / References

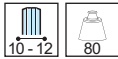

Single over panel strike box. Suits PF514.**
Single over panel strike box. Suits PF514.**



Inox Brossé
Brushed stainless steel

PF518.15



Inox poli
Polished stainless steel

PF518.16

PF528

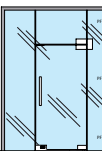
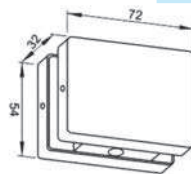
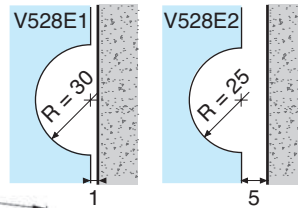

Références / References

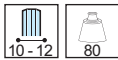

Wall to glass patch for fixed panels
Wall to glass patch for fixed panels



Inox Brossé
Brushed stainless steel

PF528.15



Inox poli
Polished stainless steel

PF528.16

Pentures,
serrures et
pièces de fixation
*Locks and
patch fittings*

Elite

 **KRAUS**
www.kraussro.sk
info@kraussro.sk :: +421 2 2092 0888

Caractéristiques techniques

- Dimensions 52x165 mm (pièces standard V500, V501, V511, V514)
- Pour verre de 8, 10 et 12 mm
- Montage sur encoche V500E (pièces standard V500, V501, V511, V514)
- Poids maximum 100 kg
- Dimensions maxi. des portes 1250 x 2350 mm ou 1000 x 2450 mm

Pour verre épaisseur 8 et 12 mm :
Commander des intercalaires complémentaires.

Technical features

- Dimensions 52x165 mm (standard fittings V500, V501, V511, V514)
- For 8, 10 and 12mm thick glass
- Assembly on notch V500E (standard fittings V500, V501, V511, V514)
- Maximum door weight 100 kg
- Maximum size for glass doors 1250 x 2350 mm or 1000 x 2450 mm

For 8 and 12 mm thick glass :
Please order additional spacers

LES + PRODUITS

The + product

Grande qualité
de finition

Gamme complète

Réversibles

High quality finishes

Full range

Reversible



INSTALLATION STANDARD

STANDARD INSTALLATION

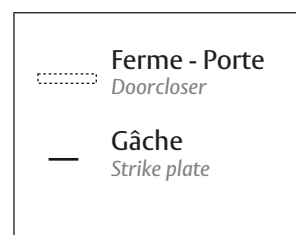
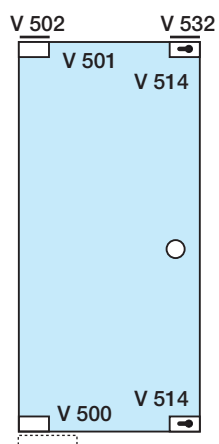
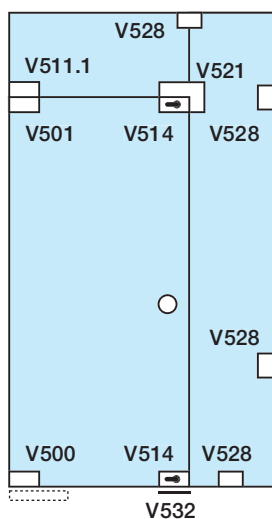
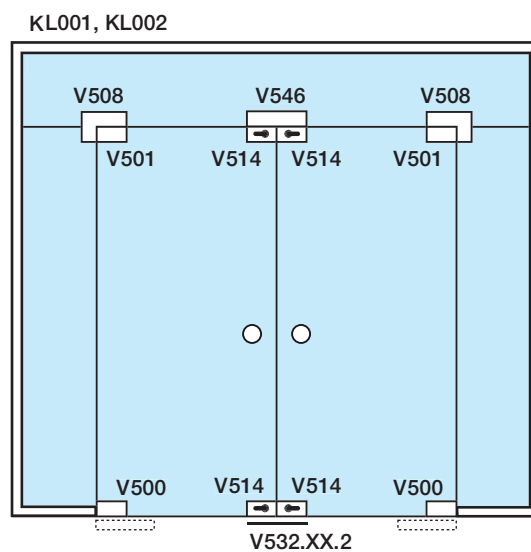
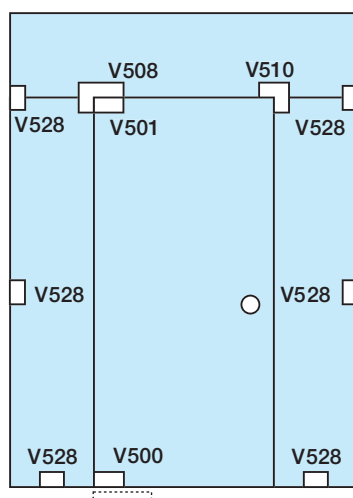
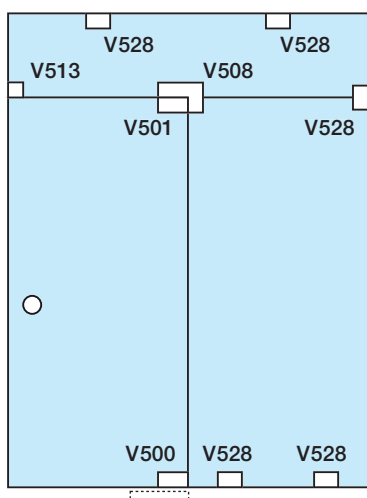
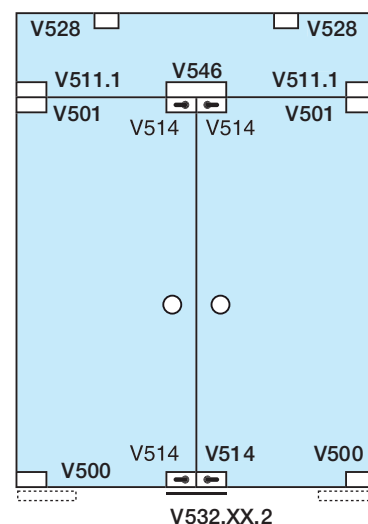
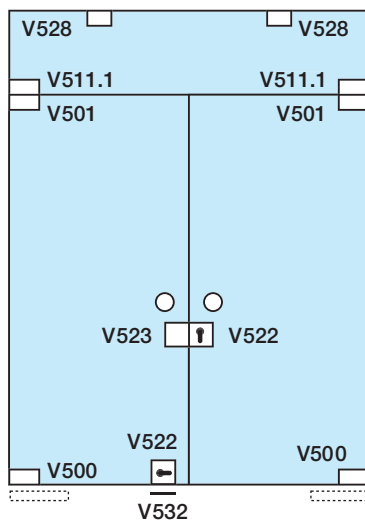
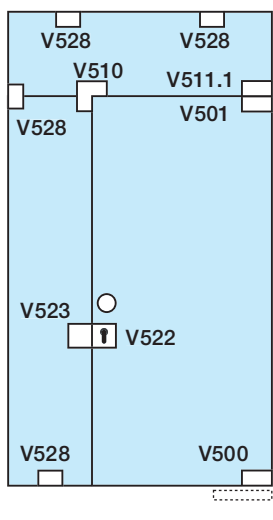
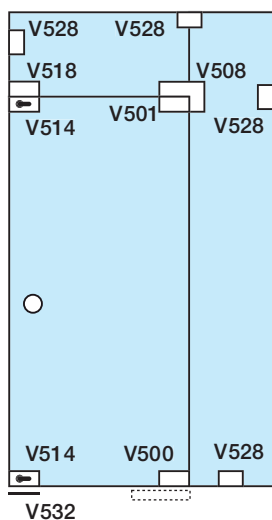

JEUX RECOMMANDÉS

RECOMMENDED TOLERANCES

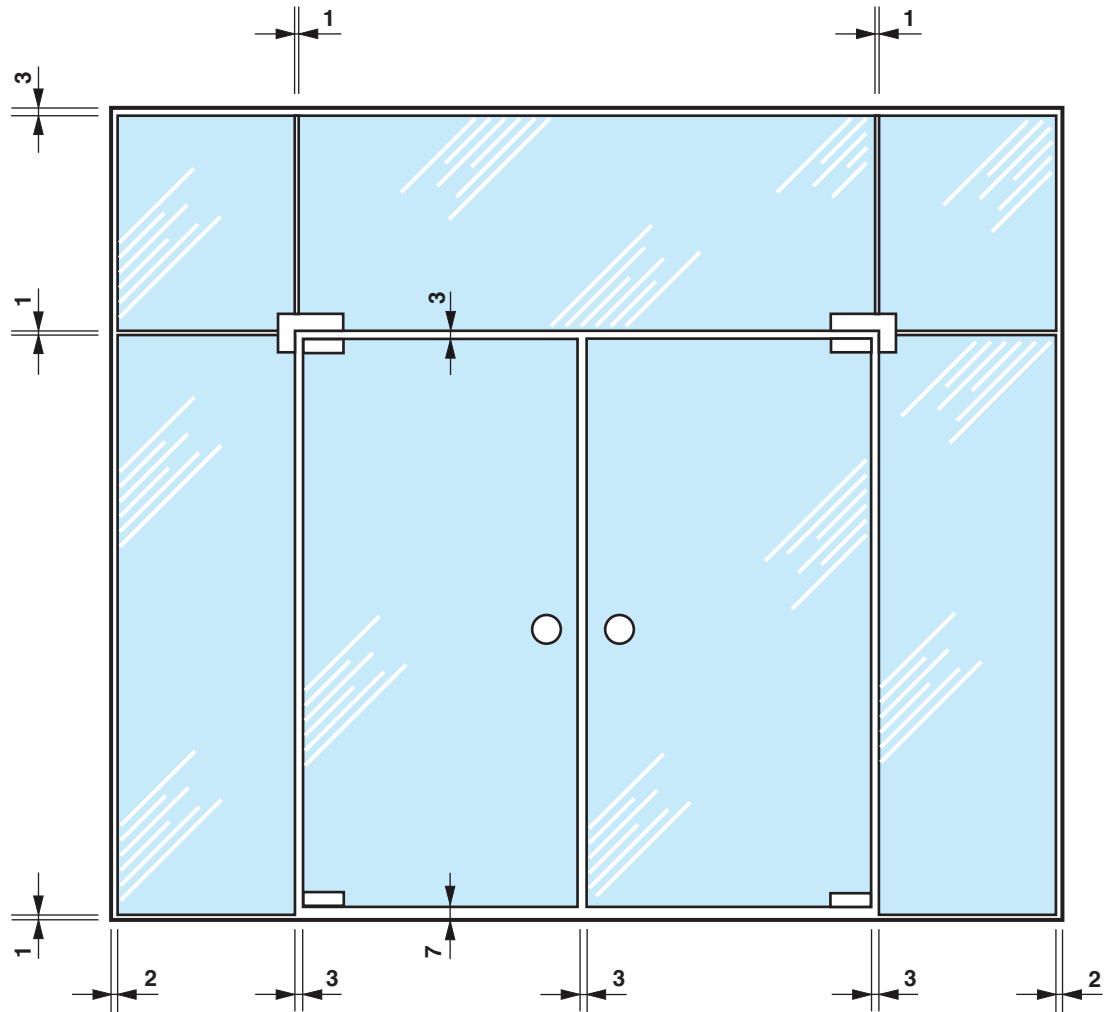

V502

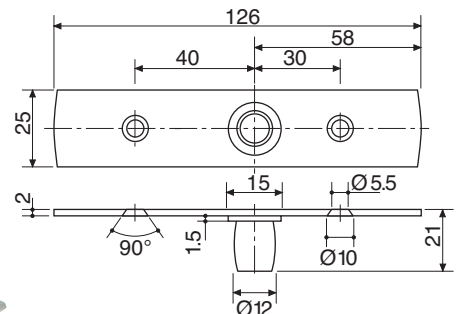
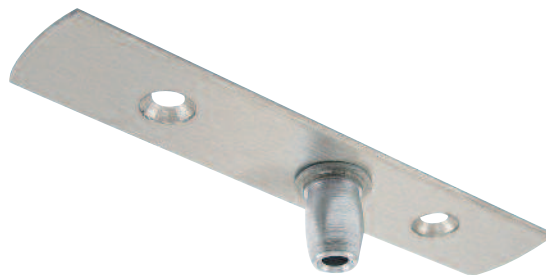

Inox Brossé
Brushed stainless steel

Références / References

Pivot supérieur pour V501/V201
Top pivot for V501/V201

V502.15

V502.3.33

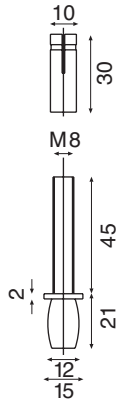

Références / References



Pivot supérieur pour V501/V201
Top pivot for V501/V201

Pentures,
serrures et
pièces de fixation
Locks and
patch fittings



V501

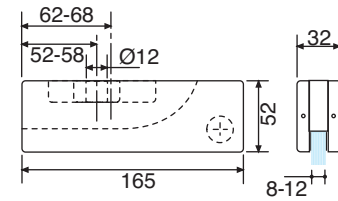
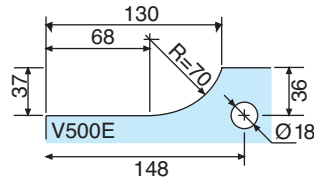
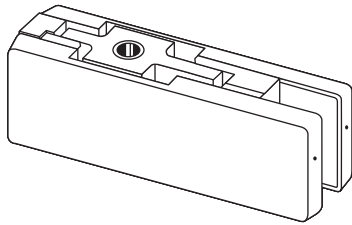

Références / References



Penture haute (Montage sur encoche V500E)
Top patch fitting (Assembly on notch V500E)

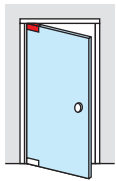

Laiton poli verni Polished varnished brass	Aluminium anodisé Argent Brossé Brushed anodised alu. silver	Inox Brossé Brushed stainless steel	Chromé brillant Bright chromium
V501.01	V501.12	V501.15	V501.30

V201

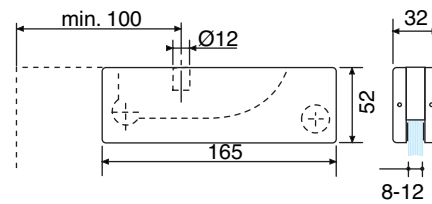
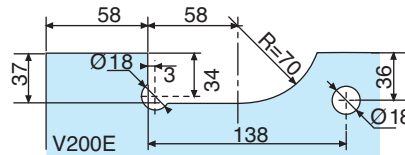
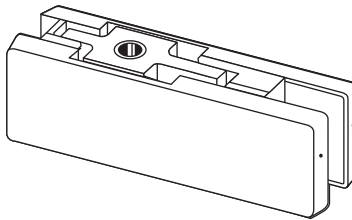

Références / References



Penture haute à rotation axiale déportée (Montage sur encoche V200E)
Top patch fitting with variable pivot point (Assembly on notch V200E)

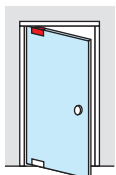

Aluminium anodisé Argent Brossé Brushed anodised alu. silver	Inox Brossé Brushed stainless steel	Chromé brillant Bright chromium
V201.12	V201.15	V201.30

V500F

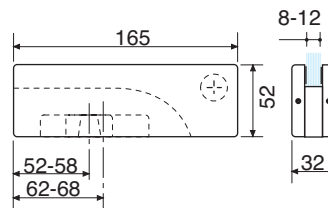
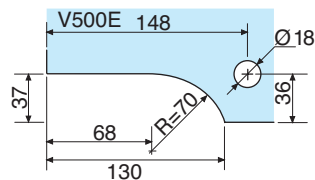
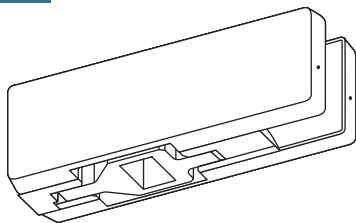

Références / References



Penture basse pour axe carré français (Montage sur encoche V500E)
Bottom patch fitting French square spindle (Assembly on notch V500E)

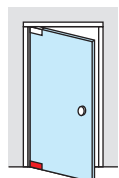

V500F.01

V500F.12

V500F.15

V500F.30



V500D

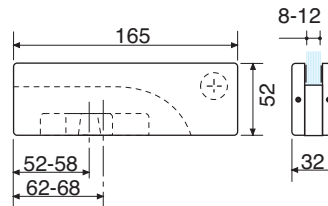
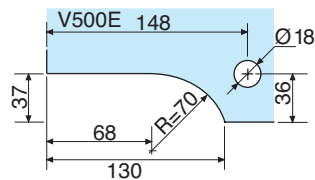
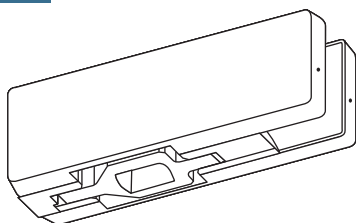

Références / References



Penture basse pour axe rectangulaire allemand (Montage sur encoche V500E)
Bottom patch fitting German rectangular spindle (Assembly on notch V500E)

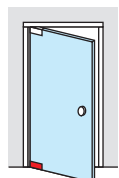

V500D.01

V500D.12

V500D.15

V500D.30

V200D

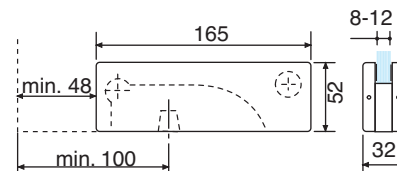
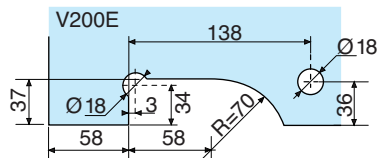
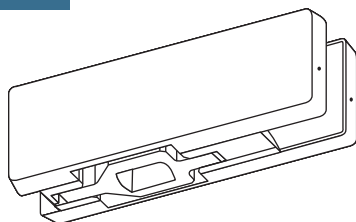

Références / References



Penture basse pour axe rectangulaire allemand à rotation axiale déportée (Montage sur encoche V200E)
Bottom patch fitting German rectangular spindle with variable pivot point (Assembly on notch V200E)

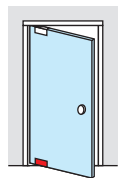

V200D.01

V200D.12

V200D.15

V200D.30

V550D

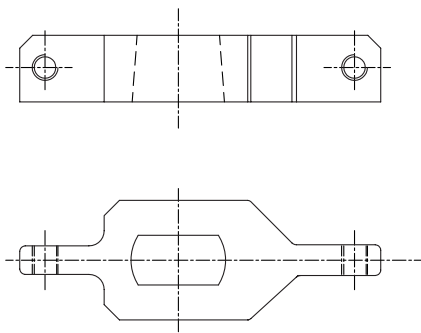

Références / References

D

Insert rectangulaire allemand pour V500 et V200
German rectangular insert for V500 and V200

 **KRAUS**
www.kraussro.sk
info@kraussro.sk :: +421 2 2092 0888

V550F

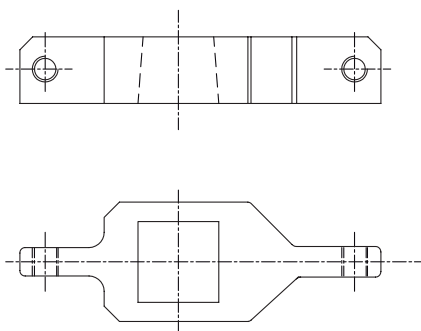

Références / References

F

Insert carré français pour V500 et V200
French square spindle for V500 and V200

V550I

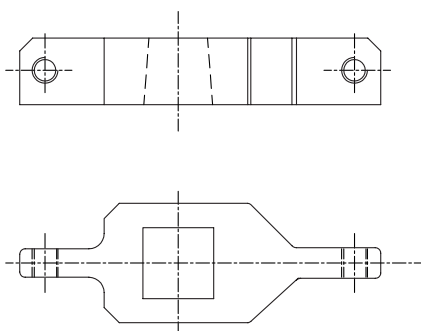

Références / References

I

Insert carré italien pour V500 et V200
Italian square spindle for V500 and V200

Pentures,
serrures et
pièces de fixation
*Locks and
patch fittings*

V535

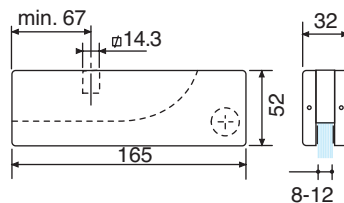
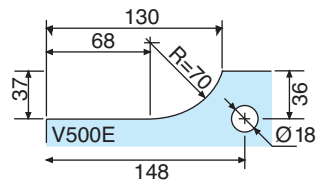
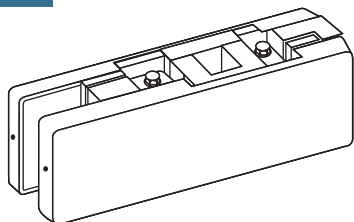

Références / References



Penture haute pour ferme porte 5600 (Montage sur encoche V500E)
Top patch fitting for door closer 5600 (Assembly on notch V500E)

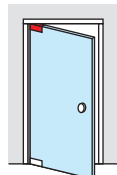

Laiton poli verni Polished varnished brass	Aluminium anodisé Argent Brossé Brushed anodised alu. silver	Inox Brossé Brushed stainless steel	Chromé brillant Bright chromium
V535.01	V535.12	V535.15	V535.30



V235

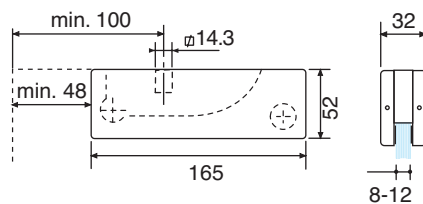
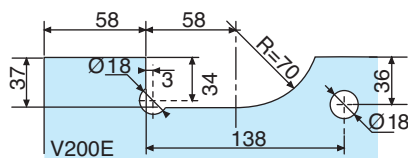
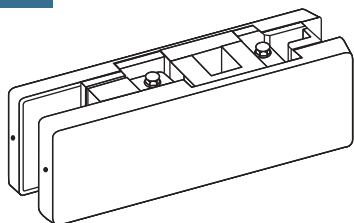

Références / References



Penture haute pour ferme porte 5600 rotation axiale déportée (Montage sur encoche V200E)
Top patch fitting for door closer 5600 with variable pivot point (To fit notch V200E)

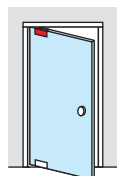

Laiton poli verni Polished varnished brass	Aluminium anodisé Argent Brossé Brushed anodised alu. silver	Inox Brossé Brushed stainless steel	Chromé brillant Bright chromium
V235.01	V235.12	V235.15	V235.30

V536

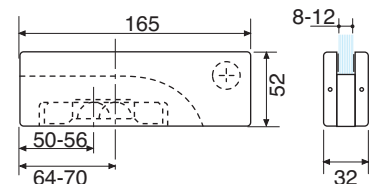
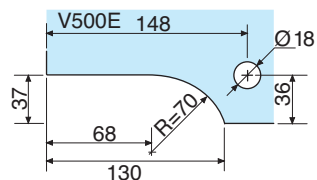
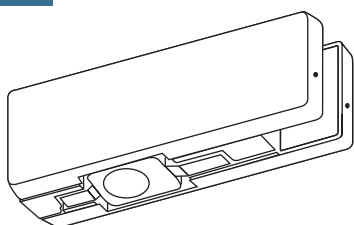

Références / References



Penture basse avec insert dome pour AC311 (Montage sur encoche V500E)
Bottom patch fitting with dome insert for AC311 (Assembly on notch V500E)

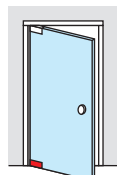

Laiton poli verni Polished varnished brass	Aluminium anodisé Argent Brossé Brushed anodised alu. silver	Inox Brossé Brushed stainless steel	Chromé brillant Bright chromium
V536.01	V536.12	V536.15	V536.30

V236

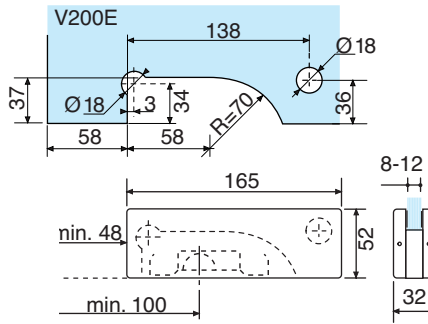
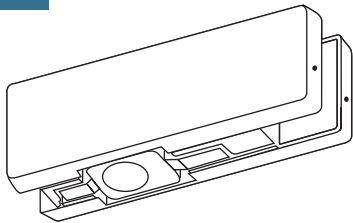

Références / References



Penture basse avec insert dome pour AC311 rotation axiale déportée (Montage sur encoche V200E)
 Bottom patch fitting with dome insert for AC311 with variable pivot point (Assembly on notch V200E)

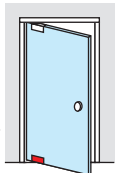

Laiton poli verni Polished varnished brass	Aluminium anodisé Argent Brossé Brushed anodised alu. silver	Inox Brossé Brushed stainless steel	Chromé brillant Bright chromium
V236.01	V236.12	V236.15	V236.30

KRAUS
 www.kraussro.sk
 info@kraussro.sk :: +421 2 2092 0888

Pentures,
 serrures et
 pièces de fixation
 Locks and
 patch fittings

AC311.15

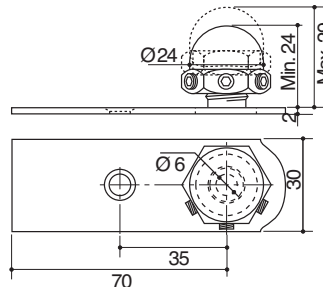

Faux pivot dome réglable pour V536
 Dome floor pivot for V536

AC246.33

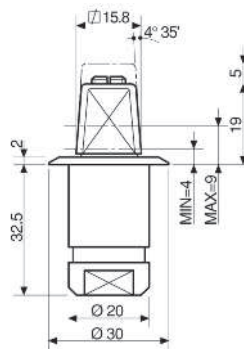

Crapaudine à sceller axe carré italien
 Adjustable Italian square free swing floor pivot

AC299.33

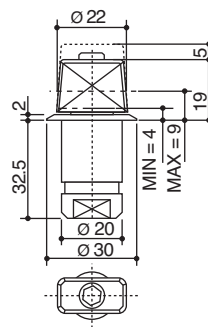

Crapaudine à sceller axe rectangulaire allemand
 Adjustable German rectangular free swing floor pivot

V511.1

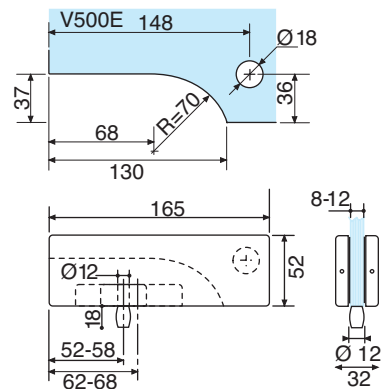
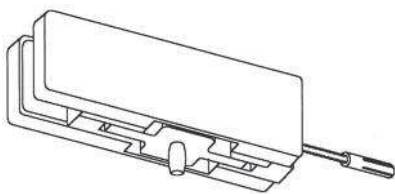

Références / References



Contre-sabot d'imposte avec tige filetée et cheville (Montage sur encoche V500E)
Side fixed transom panel patch with pivot for double acting doors with rod and plug (Assembly on notch V500E)

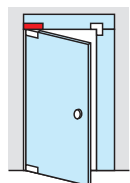

Laiton poli verni <i>Polished varnished brass</i>	Aluminium anodisé Argent Brossé <i>Brushed anodised alu. silver</i>	Inox Brossé <i>Brushed stainless steel</i>	Chromé brillant <i>Bright chromium</i>
V511.1.01	V511.1.12	V511.1.15	V511.1.30



V211

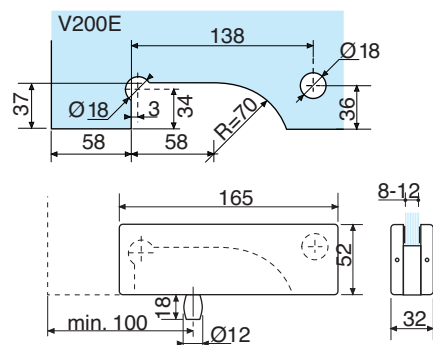
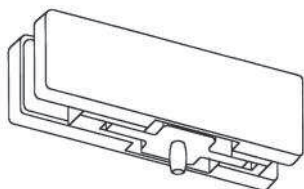

Références / References



Contre-sabot d'imposte à rotation axiale déplacée (Montage sur encoche V200E)
Transom panel patch with off-centre pivot (Assembly on notch V200E)

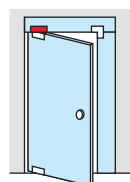

Laiton poli verni <i>Polished varnished brass</i>	Aluminium anodisé Argent Brossé <i>Brushed anodised alu. silver</i>	Inox Brossé <i>Brushed stainless steel</i>	Chromé brillant <i>Bright chromium</i>
V211.01	V211.12	V211.15	V211.30

V513

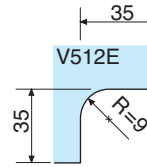
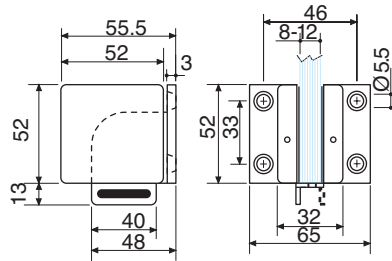
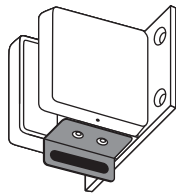

Pentures,
serrures et
pièces de fixation
Locks and
patch fittings

Références / References

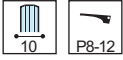

Pièce d'angle d'imposte avec plaque murale et avec butée réversible amovible (Montage sur encoche V512E)
Side fixed transom panel patch with wall plate and removable reversible stop (Assembly on notch V512E)

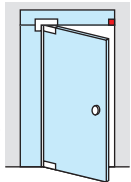

Laiton poli verni
Polished varnished brass

V513.01



Aluminium anodisé Argent Brossé
Brushed anodised alu. silver

V513.12



Inox Brossé
Brushed stainless steel

V513.15



Chromé brillant
Bright chromium

V513.30

KRAUS
www.kraussro.sk
info@kraussro.sk :: +421 2 2092 0888

V582

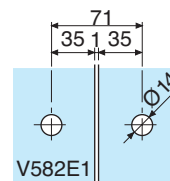
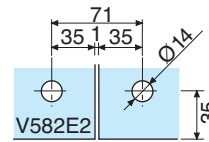
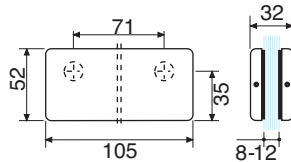
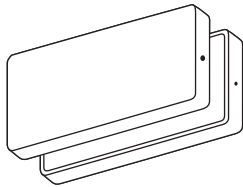

Références / References



Liaison pour 2 panneaux fixes (Montage sur encoche V582E1-V582E2)
Fixed panel connector for 2 fixed panels (Assembly on notch V582E1-V582E2)

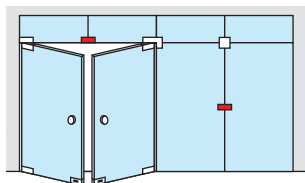

Laiton poli verni
Polished varnished brass

V582.01



Aluminium anodisé Argent Brossé
Brushed anodised alu. silver

V582.12



Inox Brossé
Brushed stainless steel

V582.15



Chromé brillant
Bright chromium

V582.30

V528

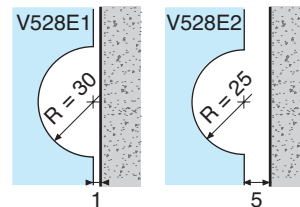
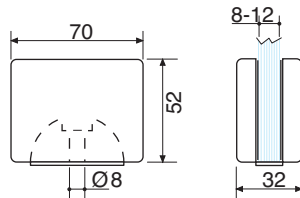
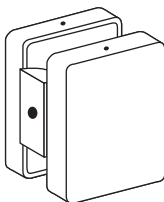

Références / References

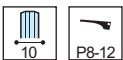

Pièce de fixation murale pour glaces fixes à vis (Montage sur encoche V528E1-V528E2)
Wall to glass patch for fixed panel to screw on (Assembly on notch V528E1-V528E2)

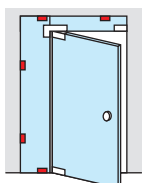

Laiton poli verni
Polished varnished brass

V528.01



Aluminium anodisé Argent Brossé
Brushed anodised alu. silver

V528.12



Inox Brossé
Brushed stainless steel

V528.15



Chromé brillant
Bright chromium

V528.30

V581

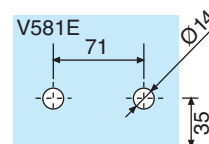
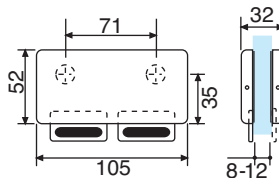
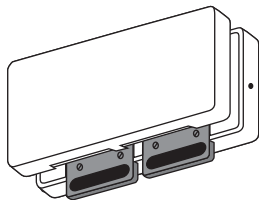

Références / References

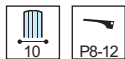

Pièce de liaison pour 2 glaces fixes avec double butée réversible (Montage sur encoche V581E)
Fixed panel connector for two fixed panels with reversible stop (Assembly on notch V581E)

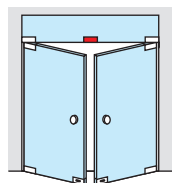

Laiton poli verni Polished varnished brass	Aluminium anodisé Argent Brossé Brushed anodised alu. silver	Inox Brossé Brushed stainless steel	Chromé brillant Bright chromium
V581.01	V581.12	V581.15	V581.30

V514

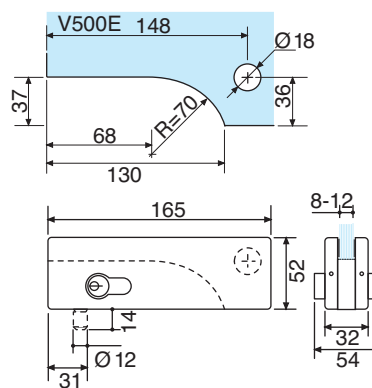
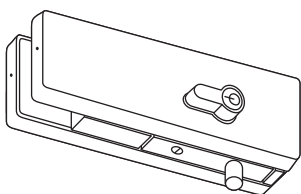

Références / References

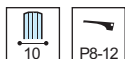

Serrure d'angle avec cylindre Européen (Montage sur encoche V500E)
Corner lock with Euro profile cylinder (Assembly on notch V500E)

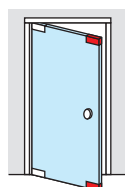

Laiton poli verni Polished varnished brass	Aluminium anodisé Argent Brossé Brushed anodised alu. silver	Inox Brossé Brushed stainless steel	Chromé brillant Bright chromium
V514.01	V514.12	V514.15	V514.30

V519.1

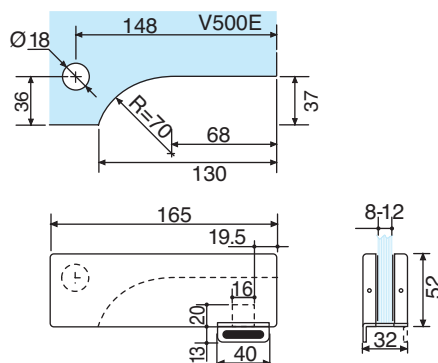
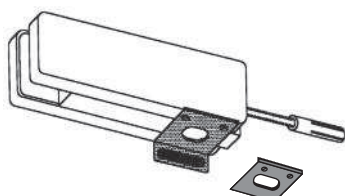

Références / References

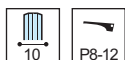

Contre-boîtier pour serrure de coin avec ou sans butée réversible et tige filetée (Montage sur encoche V500E)
Side fixed transom panel patch for corner lock with or without reversible stop, rod and plug (Assembly on notch V500E)

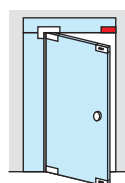

Laiton poli verni Polished varnished brass	Aluminium anodisé Argent Brossé Brushed anodised alu. silver	Inox Brossé Brushed stainless steel	Chromé brillant Bright chromium
V519.1.01	V519.1.12	V519.1.15	V519.1.30

V546

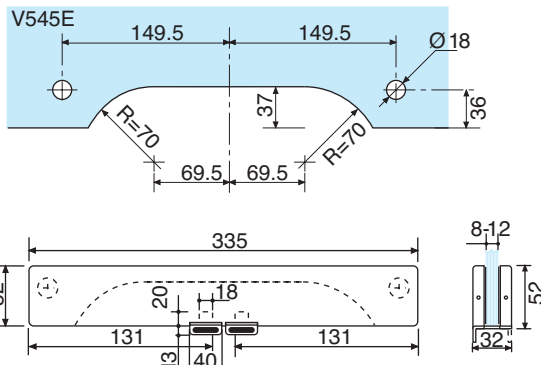
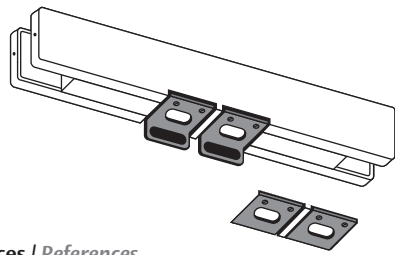

Références / References

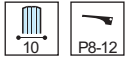

Double contre-boîtier pour serrure d'angle avec ou sans butée réversible (Montage sur encoche V500E)
 Double transom panel patch for corner lock with or without reversible stop (Assembly on notch V500E)

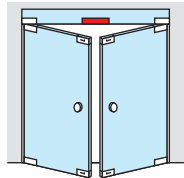

Laiton poli verni Polished varnished brass	Aluminium anodisé Argent Brossé Brushed anodised alu. silver	Inox Brossé Brushed stainless steel	Chromé brillant Bright chromium
V546.01	V546.12	V546.15	V546.30

V522

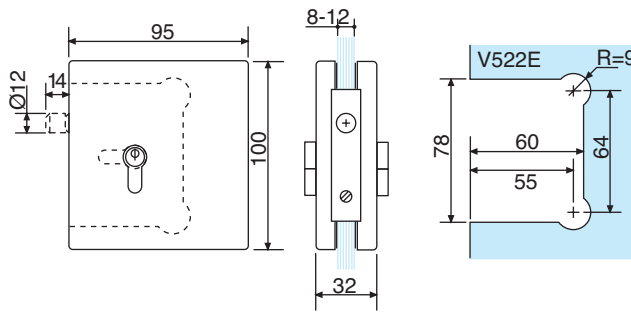
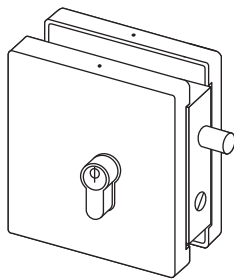

Références / References

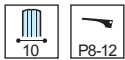

Serrure universelle à pêne dormant avec cylindre Européen (Montage sur encoche V522E)
 Reversible lock with Euro profile cylinder (Assembly on notch V522E)

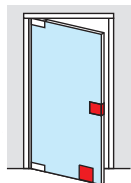

Laiton poli verni Polished varnished brass	Aluminium anodisé Argent Brossé Brushed anodised alu. silver	Inox Brossé Brushed stainless steel	Chromé brillant Bright chromium
V522.01	V522.12	V522.15	V522.30

V523

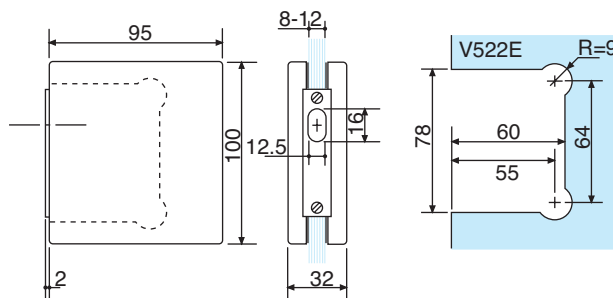
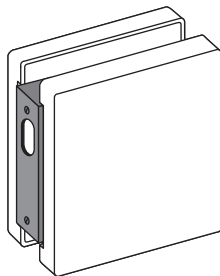

Références / References

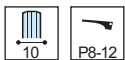

Contre-boîtier pour V522 (Montage sur encoche V522E)
 Patch keep for V522 (Assembly on notch V522E)

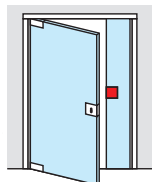

Laiton poli verni Polished varnished brass	Aluminium anodisé Argent Brossé Brushed anodised alu. silver	Inox Brossé Brushed stainless steel	Chromé brillant Bright chromium
V523.01	V523.12	V523.15	V523.30

Pentures,
serrures et
pièces de fixation
Locks and
patch fittings

KRAUS
www.kraussro.sk
info@kraussro.sk :: +421 2 2092 0888

V542.2

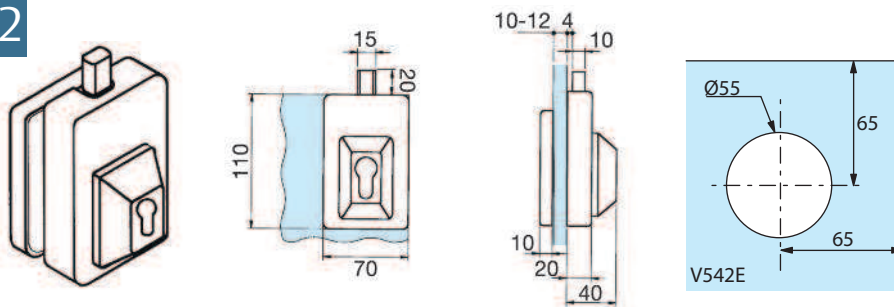



Références / References

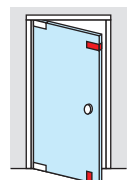

Serrure d'angle réversible pour cylindre Européen (Montage sur encoche V542E)
Reversible corner lock with Euro profile cylinder and security rosettes (Assembly on notch V542E)



		
Aluminium anodisé Argent Brossé Brushed anodised alu. silver	Inox Brossé Brushed stainless steel	Chromé brillant Bright chromium
V542.2.12	V542.2.15	V542.2.30



V515

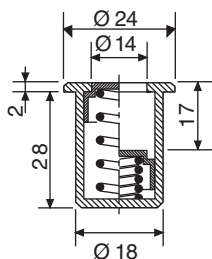

Références / References

Gâche anti-poussière pour V514 – V522
Tubular dustproof bolt keep for V514 – V522



V515.33

V532

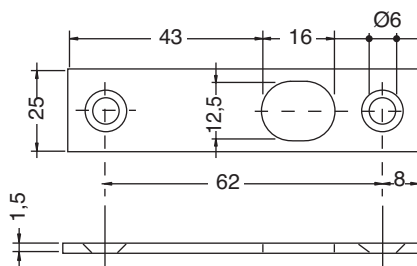

Références / References

Gâche pour V514 – V522 – V542.2 – C222
Flat keep for V514 – V522 – V542.2 – C222

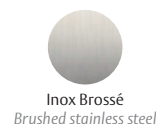

V532.15

V532.2

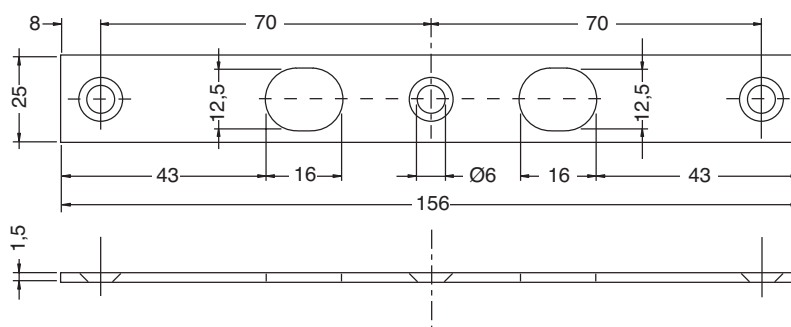

Références / References

Gâche pour 2 serrures de coin V514
Flat keep for 2 corner locks V514



V532.2.15

V510

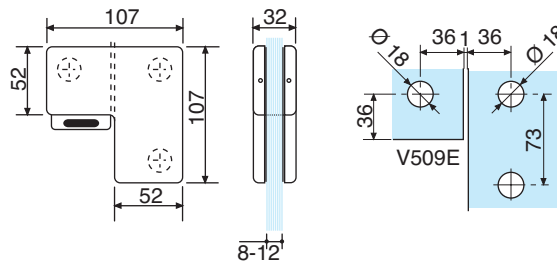
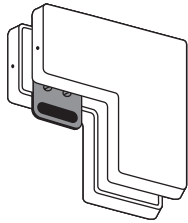

Références / References

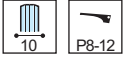

Pièce de liaison imposte et glace fixe avec butée réversible (Montage sur encoche V509E)
 Transom and side panel link patch with reversible stop (Assembly on notch V509E)

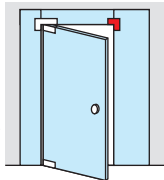

Laiton poli verni Polished varnished brass	Aluminium anodisé Argent Brossé Brushed anodised alu. silver	Inox Brossé Brushed stainless steel	Chromé brillant Bright chromium
V510.01	V510.12	V510.15	V510.30

V508

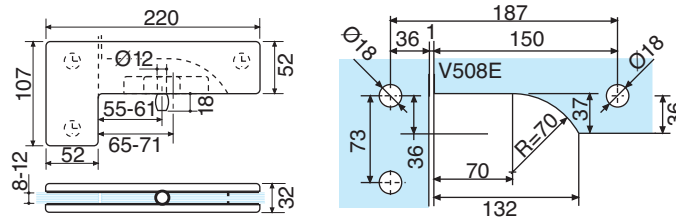
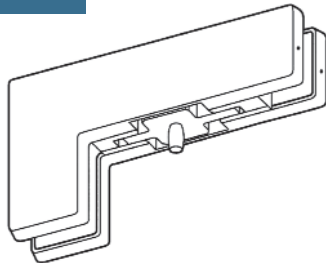

Références / References

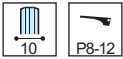

Pièce de liaison imposte et glace fixe avec pivot (Montage sur encoche V508E)
 Transom and side panel link patch with pivot (Assembly on notch V508E)

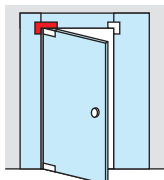

Laiton poli verni Polished varnished brass	Aluminium anodisé Argent Brossé Brushed anodised alu. silver	Inox Brossé Brushed stainless steel	Chromé brillant Bright chromium
V508.01	V508.12	V508.15	V508.30

Pentures,
serrures et
pièces de fixation
Locks and
patch fittings

KRAUS
www.kraussro.sk
info@kraussro.sk :: +421 2 2092 0888

V521

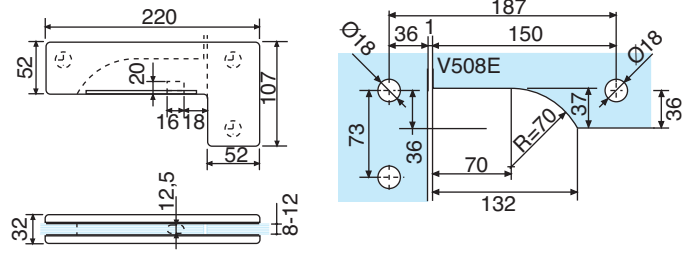
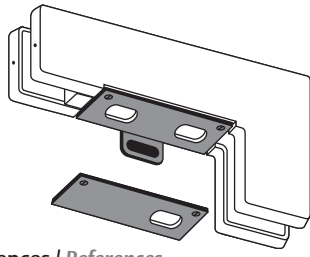

Références / References

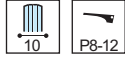

Pièce de liaison imposte et glace fixe, contre-boîtier avec ou sans butée réversible pour serrure V514 (Montage sur encoche V508E)
Transom and side panel link patch with strike with or without reversible stop for lock V514 (Assembly on notch V508E)

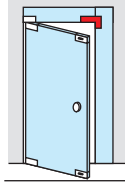

V521.01

V521.12

V521.15

V521.30

V564

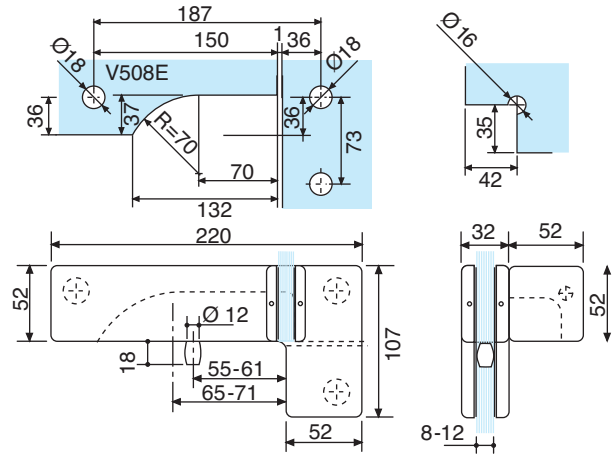
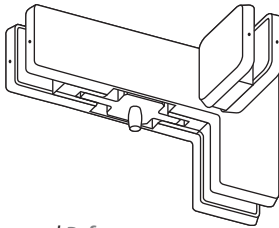

Références / References

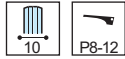

Pièce de liaison imposte et glace fixe avec pivot et ailette de contreventement (Montage sur encoche V508E + V512E1)
Transom and side panel link patch with pivot and fin link holder (Assembly on notch V508E + V512E1)

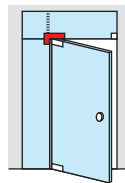

V564.12

V564.15

V565

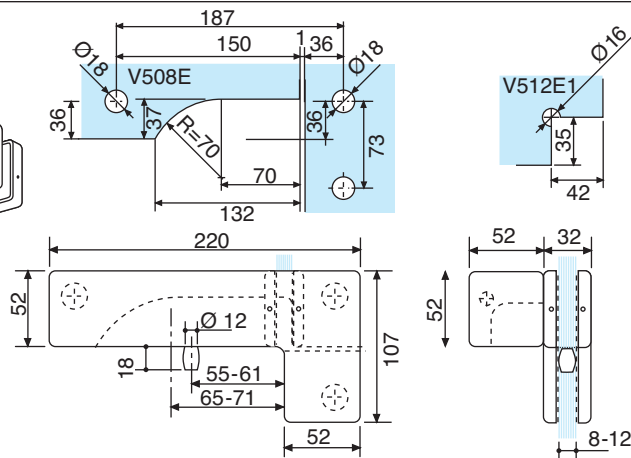
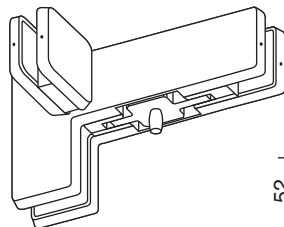

Références / References

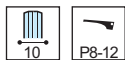

Pièce de liaison imposte et glace fixe avec pivot et ailette de contreventement (Montage sur encoche V508E + V512E)
Transom and side panel link patch with pivot and fin link holder (Assembly on notch V508E + V512E)

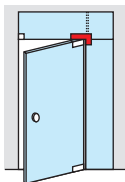

V565.12

V565.15



Serrures anti-paniques
Anti-panic locks

 **KRAUS**
www.kraussro.sk
info@kraussro.sk :: +421 2 2092 0888

ASSA ABLOY

Serrures
anti-paniques
Anti-panic locks



LES + PRODUITS

The + product

Adaptée
pour porte en verre

Esthétique

*Adapted
to glass doors*

Aesthetic

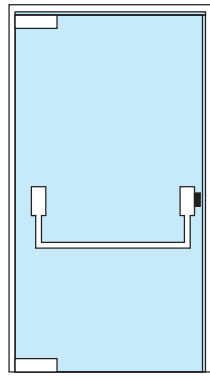

Porte A / Door A

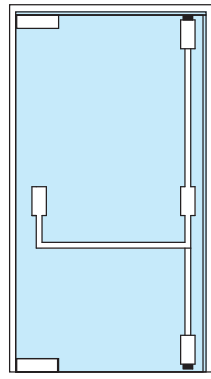

Porte B / Door B

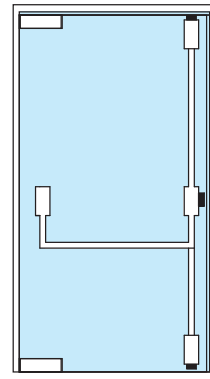

Porte C / Door C

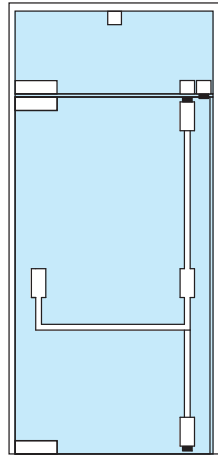

Porte D / Door D

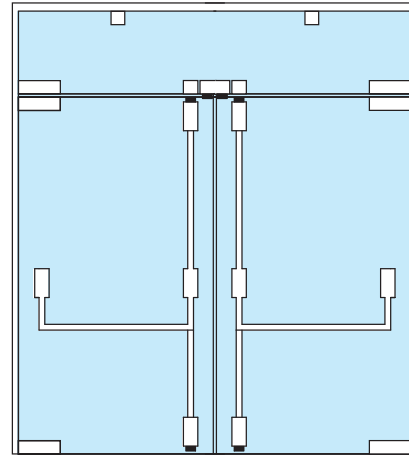

Porte E / Door E

ARTICLES NÉCESSAIRES / REFERENCES NEEDED

Type de condamnation <i>Closing Type</i>	M1040 + V586 Encoche N°1 <i>Notch N°1</i>	A022330 + V587 Encoche N°2 <i>Notch N°2</i>	V588 Encoche N°6 <i>Notch N°6</i>	A041730 Poignée Ext. <i>Ext. Handle</i>
Porte A / Door A	1			1
Porte B / Door B	1	1		1
Porte C / Door C	1	1		1
Porte D / Door D	1	1	1	1
Porte E / Door E	2	2	2	2

M1040 + V586

Serrures
anti-paniques
Anti-panic locks

KRAUS
www.kraussro.sk
info@kraussro.sk :: +421 2 2092 0888

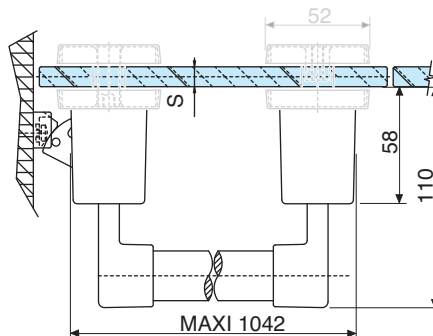
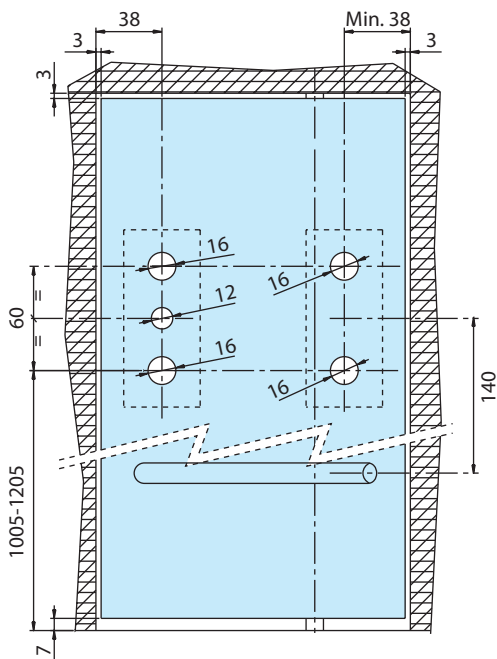

M1040

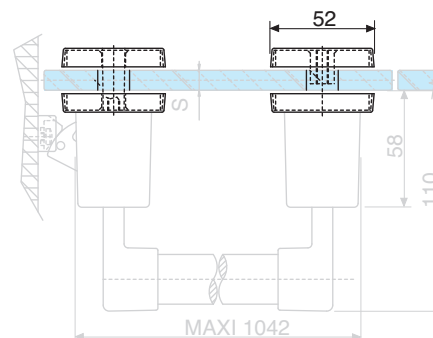

V586

Références / References

M1040

Barre anti-panique pour sortie de secours (995 mm),
montage sur verre avec accessoire V586
Anti panic device for single glass door to fit on glass with accessory V586.



Laqué argent
Lacquered silver



Laqué noir
Lacquered black

M1040.73

M1040.52

V586



Aluminium anodisé Argent Brossé
Brushed anodised alu. silver



Aluminium anodisé noir
Black Anodised

V586.12

V586.19

Accessoire pour montage du mécanisme
de fermeture latérale M1040 (Montage sur encoche)
*Pair of glass fitting, for side latch mechanism for M1040 panic
exit device (Assembly on notch)*

Serrures
anti-paniques
Anti-panic locks

AO22330 + V587

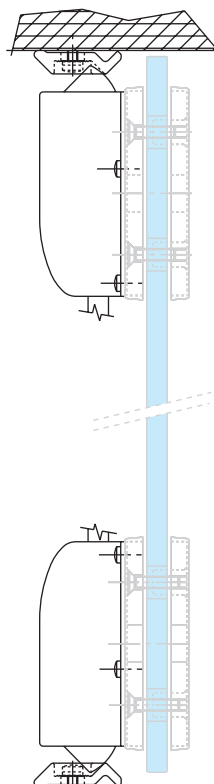
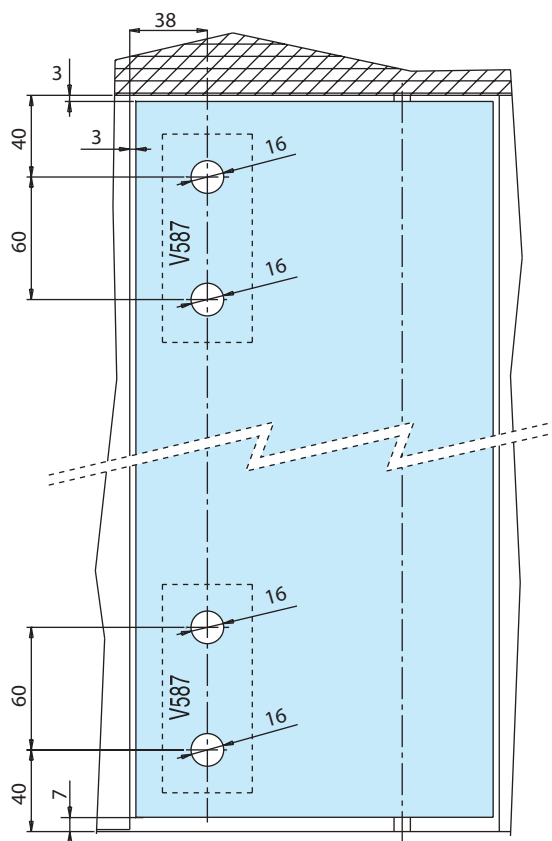

AO22330

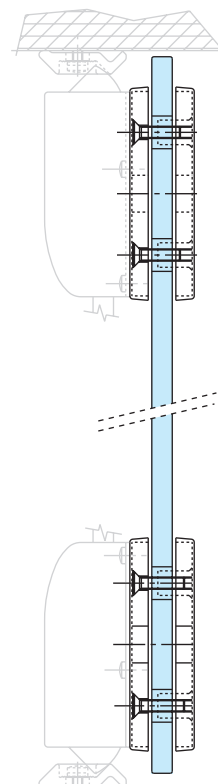

V587

KRAUS
www.krausro.sk
info@krausro.sk :: +421 2 2092 0888

Références / References

AO22330

Mécanisme de fermeture supérieur et inférieur
avec tringles et butées, pour porte jusqu'à 2500 mm,
montage sur verre avec accessoire V587

*Top and bottom latches, strikers and vertical rods for doors up to
2500 mm to fit on the glass with accessory V587*



Laqué argent
Lacquered silver

AO22330.73



Laqué noir
Lacquered black

AO22330.52

V587



Accessoire pour montage du mécanisme supérieur
et inférieur AO22330 (Montage sur encoche)
*Pair of supports for top and bottom latch to fit accessory
AO22330 (Assembly on notch)*



Aluminium anodisé Argent Brossé
Brushed anodised alu. silver

V587.12



Aluminium anodisé noir
Black Anodised

V587.19

V588

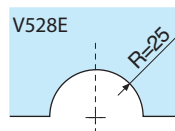
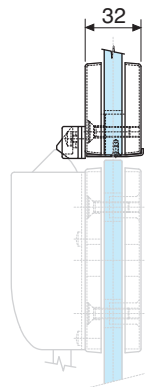

Aluminium anodisé Argent Brossé
Brushed anodised alu. silver



Aluminium anodisé noir
Black Anodised

V588.12

V588.19

Références / References



Boîtier gâche supérieur montage sur imposte
Matching patch keep to fit on overhead panel

Serrures
anti-paniques
Anti-panic locks

KRAUS
www.krausro.sk
info@krausro.sk :: +421 2 2092 0888

AO41730

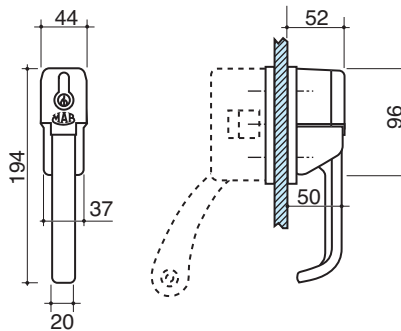

Laqué argent
Lacquered silver



Laqué noir
Lacquered black

AO41730.73

AO41730.52

Références / References

Poignée de manoeuvre extérieure à cylindre
(manoeuvrable avec clé uniquement). Utilisation avec M1040.
Handle with locking cylinder (opening with key only).
Use with M104





Plinthes
Door rails

 **KRAUS**
www.kraussro.sk
info@kraussro.sk :: +421 2 2092 0888

ASSA ABLOY

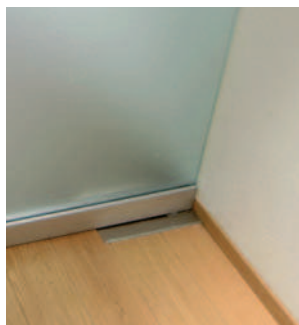

Caractéristiques techniques

- Hauteur 100 mm
- Pour verre de 10 et 12 mm
- Montage sans encoche
- Poids maximum 300 kg
- Porte maxi 1400 x 2400 mm
- Montage à l'aide de vis invisible

Technical features

- Height 100 mm
- For 10 and 12 mm thick glass
- No notches needed
- Maximum door weight 300 kg
- Maximum door size 1400 x 2400 mm
- Clamping by using invisible screws

Jeux recommandés.

Recommended tolerances.

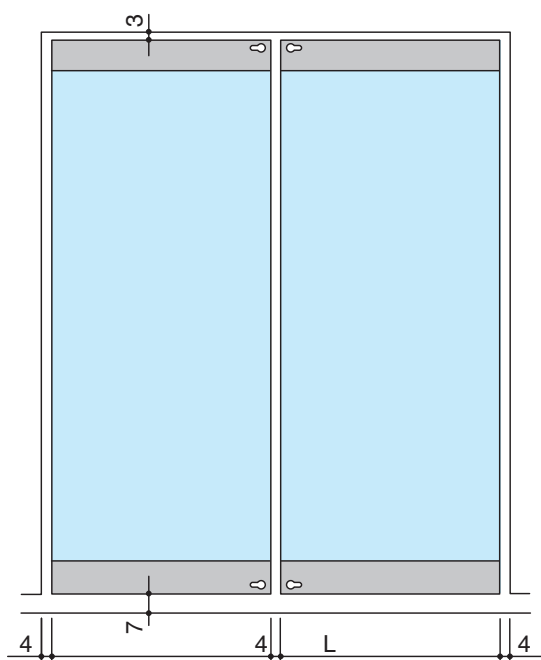

Préparation du verre.

Glass preparation.

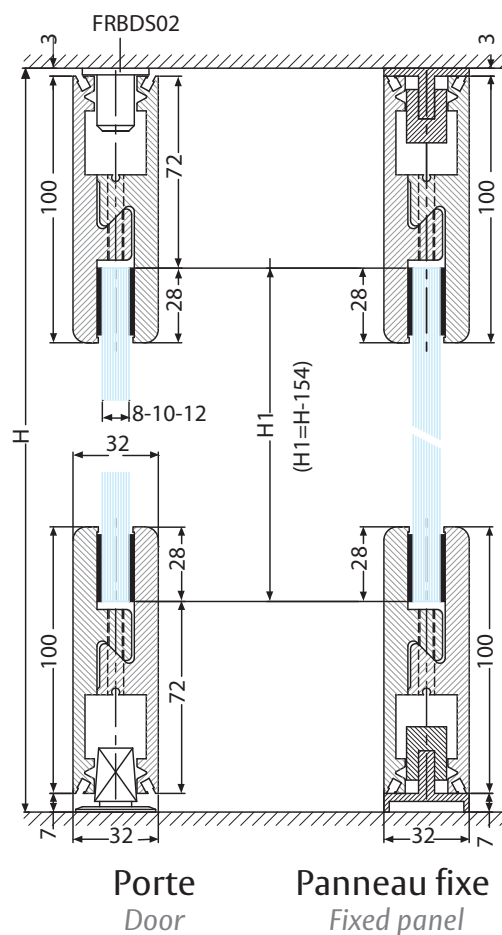

FRBDS02.99

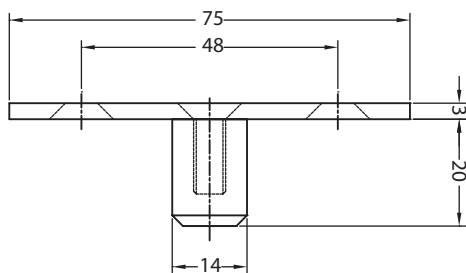

Plinthes
Door rails



Pivot haut pour plinthe haute FRP02
Top pivot for top door rail FRP02

FRP02B

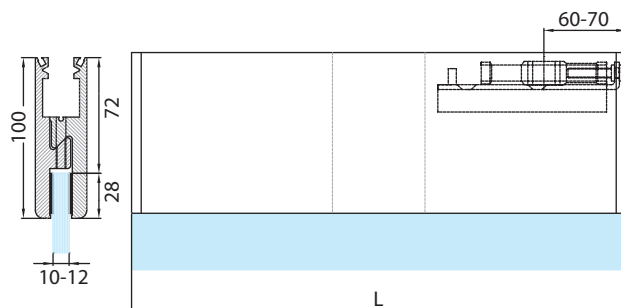
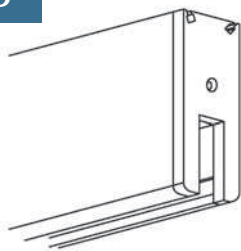

Références / References

Plinthe supérieure hauteur 100 mm avec insert et embouts
Top rail 100 mm high with pivot block and end caps



Pour verre de 10 mm
For 10 mm glass

FRP02B/10.12

FRP02B/10.36



Pour verre de 12 mm
For 12 mm glass

FRP02B/12.12

FRP02B/12.36

FRP02BL

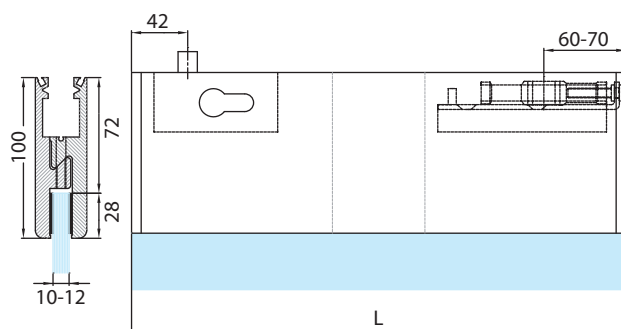
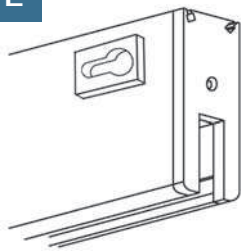

Références / References

Plinthe supérieure hauteur 100 mm avec insert, embouts, serrure et cylindre
Top rail 100 mm high with pivot block, end caps, lock and cylinder



Pour verre de 10 mm
For 10 mm glass

FRP02BL/10.12

FRP02BL/10.36



Pour verre de 12 mm
For 12 mm glass

FRP02BL/12.12

FRP02BL/12.36

FRP020

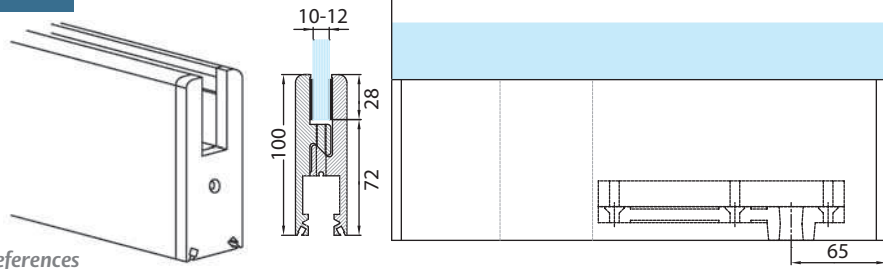

Références / References

  Plinthe inférieure hauteur 100 mm avec insert carré italien et embouts
Bottom rail 100 mm high with Italian square spindle and end caps

 Aluminium anodisé Argent Brossé
Brushed anodised alu. silver

 Aluminium anodisé Aninox
Brushed anodised alu. aninox

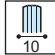
 Pour verre de 10 mm
For 10 mm glass

FRP020/10.12

FRP020/10.36

 Pour verre de 12 mm
For 12 mm glass

FRP020/12.12

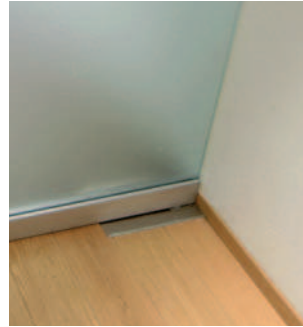

FRP020/12.36



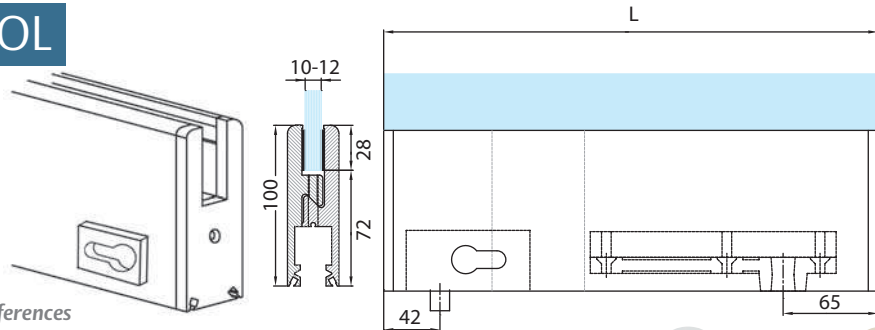

FRP020L



Références / References

  Plinthe inférieure hauteur 100 mm avec insert carré italien, embouts, serrure et cylindre
Bottom rail 100 mm high with Italian square spindle and end caps, lock and cylinder

 Aluminium anodisé Argent Brossé
Brushed anodised alu. silver

 Aluminium anodisé Aninox
Brushed anodised alu. aninox

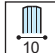
 Pour verre de 10 mm
For 10 mm glass

FRP020L/10.12

FRP020L/10.36

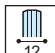
 Pour verre de 12 mm
For 12 mm glass

FRP020L/12.12

FRP020L/12.36

FRP07B

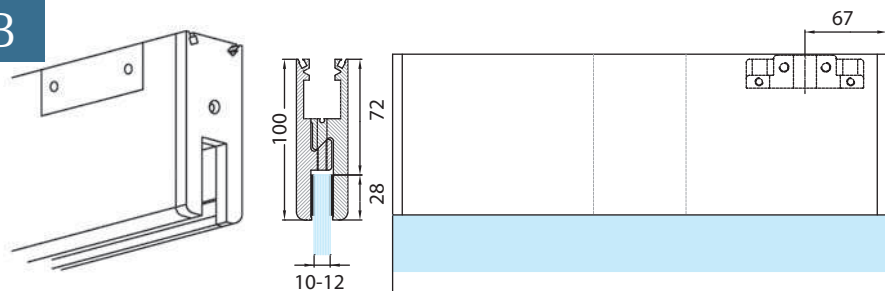

Références / References

Plinthe supérieure hauteur 100 mm avec insert pour ferme porte encastré série 5600 et embouts
Top rail 100 mm high with pivot block for closers series 5600 and end caps

 Aluminium anodisé Argent Brossé
Brushed anodised alu. silver

 Aluminium anodisé Aninox
Brushed anodised alu. aninox

 Pour verre de 10 mm
For 10 mm glass

FRP07B/10.12

FRP07B/10.36

 Pour verre de 12 mm
For 12 mm glass

FRP07B/12.12

FRP07B/12.36

FRP07BL

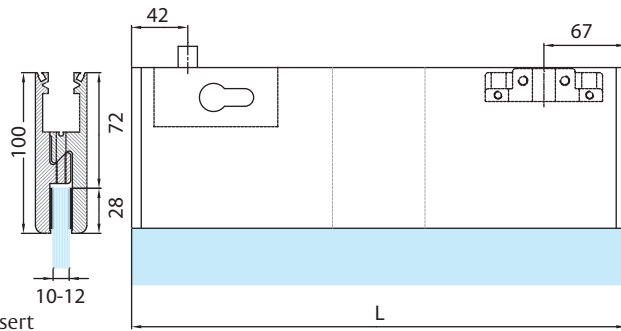
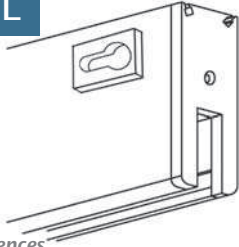

Références / References

Plinthe supérieure hauteur 100 mm avec insert pour ferme porte encastré série 5600 et embouts
Top rail 100 mm high with pivot block for closers series 5600 and end caps

Aluminium anodisé Argent Brossé
Brushed anodised alu. silver

Aluminium anodisé Aninox
Brushed anodised alu. aninox

KRAUS
www.kraussro.sk
info@kraussro.sk :: +421 2 2092 0888



Pour verre de 10 mm
For 10 mm glass

FRP07BL/10.12

FRP07BL/10.36



Pour verre de 12 mm
For 12 mm glass

FRP07BL/12.12

FRP07BL/12.36

FRP06B

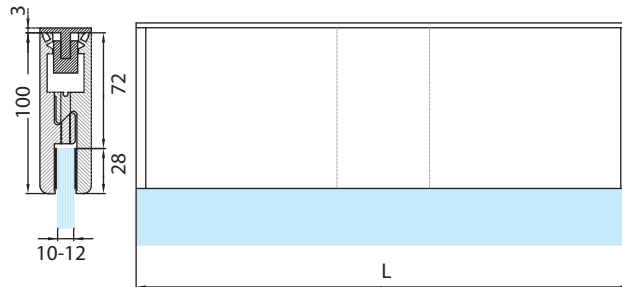
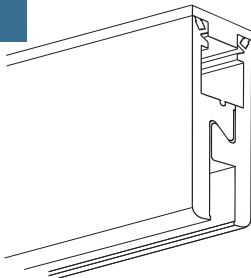

Références / References

Plinthe haute sans embout, hauteur 100 mm pour volumes fixes + Profilé supérieur de remplissage 3 mm
Top rail 100 mm high for fixed panels, without end caps + 3 mm Top filler profile

Aluminium anodisé Argent Brossé
Brushed anodised alu. silver

Aluminium anodisé Aninox
Brushed anodised alu. aninox



Pour verre de 10 mm
For 10 mm glass

FRP06B/10.12

FRP06B/10.36



Pour verre de 12 mm
For 12 mm glass

FRP06B/12.12

FRP06B/12.36

FRP06O

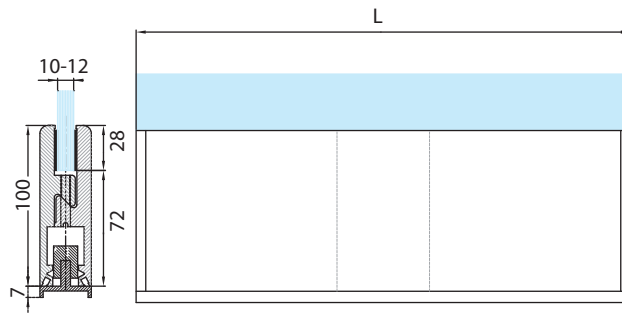
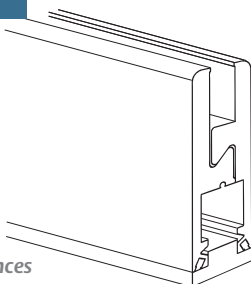

Références / References

Plinthe basse sans embout, hauteur 100 mm pour volumes fixes + Profilé inférieur de remplissage 7 mm
Bottom rail 100 mm high for fixed panels, without end caps + 7 mm bottom filler profile

Aluminium anodisé Argent Brossé
Brushed anodised alu. silver

Aluminium anodisé Aninox
Brushed anodised alu. aninox



Pour verre de 10 mm
For 10 mm glass

FRP06O/10.12

FRP06O/10.36



Pour verre de 12 mm
For 12 mm glass

FRP06O/12.12

FRP06O/12.36

FRE14.99

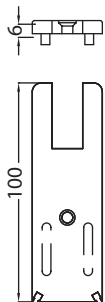

Argent métallisé
Metallic silver



Noir mat
Black matt

Références / References

Embout noir avec vis
Black end cap including screw

FRE14.73

FRE14.74

FRB**

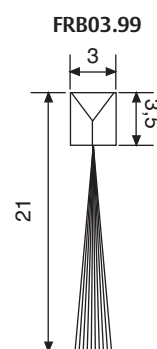
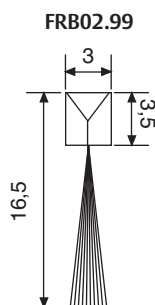
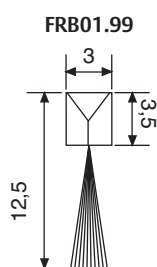
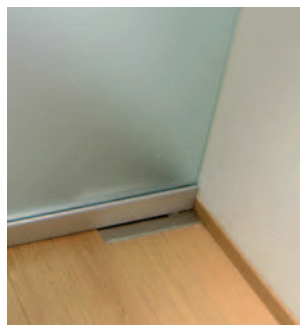

Références / References

Brosse d'étanchéité longueur 2 m pour jeu de 7 mm
Brushes length 2m for a tolerance of 7 mm

FRB01.99

Brosse d'étanchéité longueur 2 m pour jeu de 9 mm
Brushes length 2m for a tolerance of 9 mm

FRB02.99

Brosse d'étanchéité longueur 2 m pour jeu de 13 mm
Brushes length 2m for a tolerance of 13 mm

FRB03.99



• Kuchynka
• Kuchynka
• Kuchynka
• Kuchynka
• Kuchynka
• Kuchynka
• Kuchynka
• Kuchynka
• Kuchynka
• Kuchynka

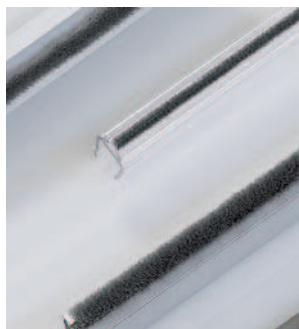

Caractéristiques techniques

- Pour verre de 8, 10, 12, 15 et 19 mm
- Montage sans encoche

Technical features

- For 8, 10, 12, 15 and 19 mm thick glass
- No notches needed

KRAUS
www.kraussro.sk
info@kraussro.sk :: +421 2 2092 0888

2810.xx.L3000

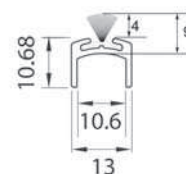

Références / References



Joint U avec brosse centrale
U profile with brush



Aluminium anodisé Argent Brossé
Brushed anodised alu. silver



Aluminium anodisé Aninox
Brushed anodised alu. aninox

2810.12.L3000

2810.36.L3000

2812.xx.L3000

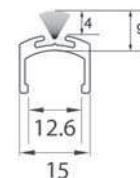

Références / References



Joint U avec brosse centrale
U profile with brush



Aluminium anodisé Argent Brossé
Brushed anodised alu. silver



Aluminium anodisé Aninox
Brushed anodised alu. aninox

2812.12.L3000

2812.36.L3000

2809.**.4

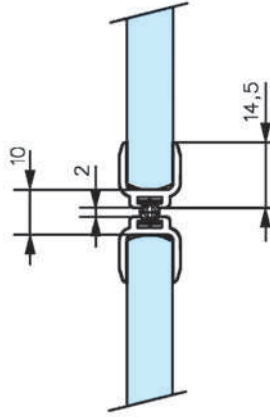
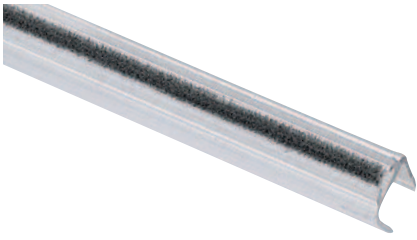

Translucide
Translucent

Références / References



Joint translucide avec brosse axée
Translucent sealing strip with central brush

2809.66.4

2810.10.*

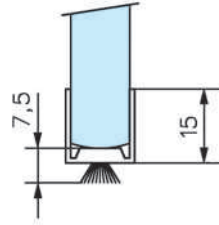

Aluminium anodisé Argent satiné
Satin anodised alu. silver

Références / References

Joint aluminium avec brosse axée
Aluminium sealing strip with central brush

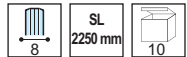

Pour verre de 8 mm
For 8 mm glass

2810.10.3

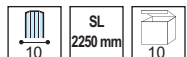

Pour verre de 10 mm
For 10 mm glass

2810.10.4

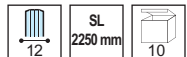

Pour verre de 12 mm
For 12 mm glass

2810.10.5

2811.10.*

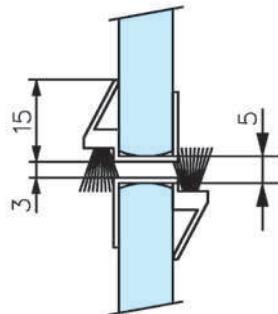
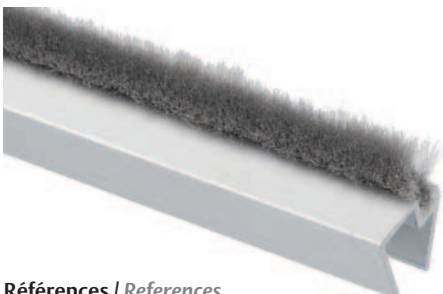

Aluminium anodisé Argent satiné
Satin anodised alu. silver

Références / References

Joint aluminium avec brosse déportée
Aluminium sealing strip with off set brush

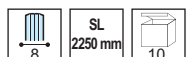

Pour verre de 8 mm
For 8 mm glass

2811.10.3

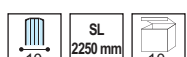

Pour verre de 10 mm
For 10 mm glass

2811.10.4

2811

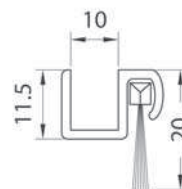
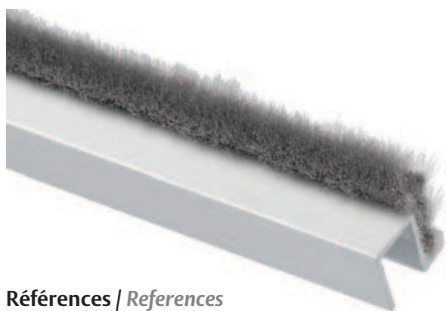

Références / References

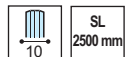

Joint aluminium U avec brosse axée
Aluminium U sealing strip with off set brush

Aluminium anodisé Argent Brossé
Brushed anodised alu. silver

2811.12

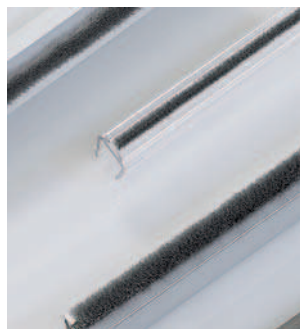

FRKB01.99

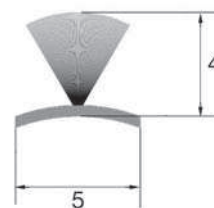

Brosse autocollante pour toutes les épaisseurs de verre - le mètre
Brush self-adhesive for all glass thicknesses - per metre

28131



Références / References

Joint aluminium avec brosse autocollante longueur 1030mm pour toutes les épaisseurs de verre
Aluminium brush profile self-adhesive length 1030mm for all glass thicknesses

Aluminium anodisé Argent Brossé
Brushed anodised alu. silver

28131.12

• Livré avec 2 embouts

• Supplied with 2 end caps

2813



Aluminium anodisé Argent Brossé
Brushed anodised alu. silver

KRAUS
www.kraussro.sk
info@kraussro.sk :: +421 2 2092 0888

Références / References

Joint aluminium avec brosse autocollante longueur 2500 mm pour toutes les épaisseurs de verre
Aluminium brush profile self-adhesive length 2500 mm for all glass thicknesses

2813.12

• Livré avec 2 embouts

• Supplied with 2 end caps

2813L.99



Références / References

Embout gauche pour joint brosse 2813
Cover cap Left for brush profile 2813

2813R.99



Références / References

Embout droite pour joint brosse 2813
Cover cap Right for brush profile 2813

U151515



Références / References

SL Profil U 15x15x15x2mm (le mètre)
6000 mm U-profile 15x15x15x2mm (per metre)



U151515.12

U151515.36

U151515.51

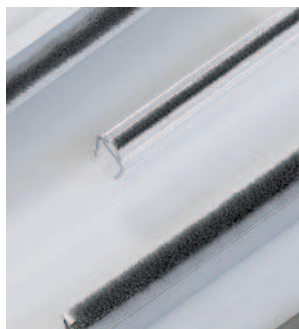

U202020



Références / References

SL Profil U 20x20x20x2mm (le mètre)
6000 mm U-profile 20x20x20x2mm (per metre)



U202020.12

U202020.36

U302030

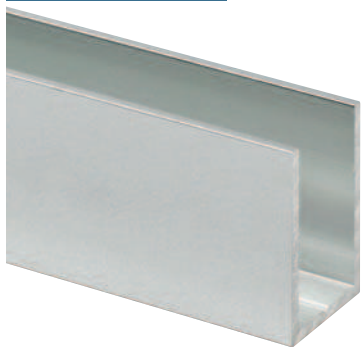

Références / References

SL Profil U 30x20x30x2mm (le mètre)
6000 mm U-profile 30x20x30x2mm (per metre)



U302030.12

U302030.36

Profils U et L décor alu poli brillant

U and L profiles Polished aluminium finish



Alu poli brillant
Polished aluminium

Références / References

Profil U 15x15x15x2 mm largeur intérieure 11 mm longueur de 3000 mm <i>U-profile 15x15x15x2 mm 11 mm inside width 3000 mm length</i>	U151515.13
Profil U 20x12x20x1,5 mm largeur intérieure 9 mm longueur de 3000 mm <i>U-profile 20x12x20x1,5 mm 9 mm inside width 3000 mm length</i>	U201220.13
Profil U 20x15x20x2 mm largeur intérieure 11 mm longueur de 3000 mm <i>U-profile 20x15x20x2 mm 11 mm inside width 3000 mm length</i>	U201520.13
Profil U 20x17x20x2 mm largeur intérieure 13 mm longueur de 3000 mm <i>U-profile 20x17x20x2 mm 13 mm inside width 3000 mm length</i>	U201720.13
Profil U 20x20x20x2 mm largeur intérieure 16 mm longueur de 3000 mm <i>U-profile 20x20x20x2 mm 16 mm inside width 3000 mm length</i>	U202020.13
Profil U 30x20x30x2 mm largeur intérieure 16 mm longueur de 3000 mm <i>U-profile 30x20x30x2 mm 16 mm inside width 3000 mm length</i>	U302030.13
Profil U 40x20x40x2 mm largeur intérieure 16 mm longueur de 3000 mm <i>U-profile 40x20x40x2 mm 16 mm inside width 3000 mm length</i>	U402040.13
Profil L 15x15x2 mm longueur de 3000 mm <i>L-profile 15x15x2 mm 3000 mm length</i>	L1515.13
Profil L 20x20x2 mm longueur de 3000 mm <i>L-profile 20x20x2 mm 3000 mm length</i>	L2020.13
Profil L 25x25x2 mm longueur de 3000mm <i>L-profile 25x25x2 mm 3000 mm length</i>	L2525.13

Quantités minimum de commande par référence = 5 longueurs

Quantités de lots par référence = 5 longueurs

Minimum quantity per order and per reference = 5 lengths

Sold in packs per reference = 5 lengths

KL001

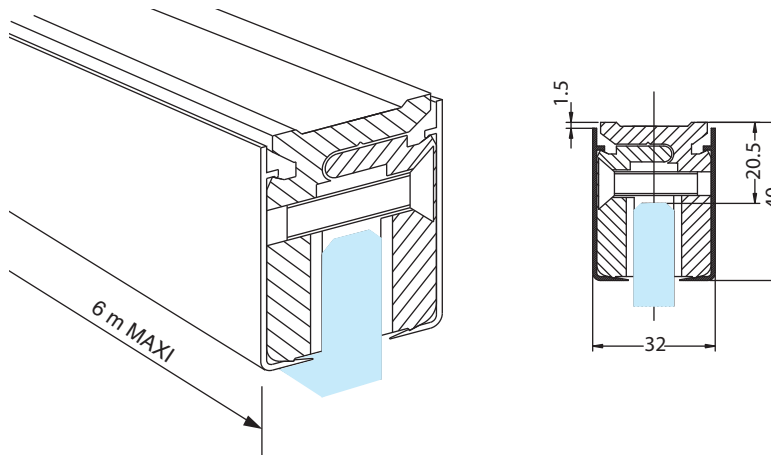

Verre suspendu poids maxi : 40 kg par mètre courant
Hanging glass maximum weight : 40 kg per running metre

Références / References

EL 6000	40	Profil de serrage pour panneaux fixes avec caches, sans encoches (le mètre) <i>Glass clamp profile incl. covers, no notch (per meter)</i>	Aluminium anodisé Argent Brossé <i>Brushed anodised alu. silver</i>	Aluminium anodisé Aninox <i>Brushed anodised alu. aninox</i>
		Pour verre de 8 mm <i>For 8 mm glass</i>	KL001/08.12	KL001/08.36
		Pour verre de 10 mm <i>For 10 mm glass</i>	KL001/10.12	KL001/10.36
		Pour verre de 12 mm <i>For 12 mm glass</i>	KL001/12.12	KL001/12.36

KL002

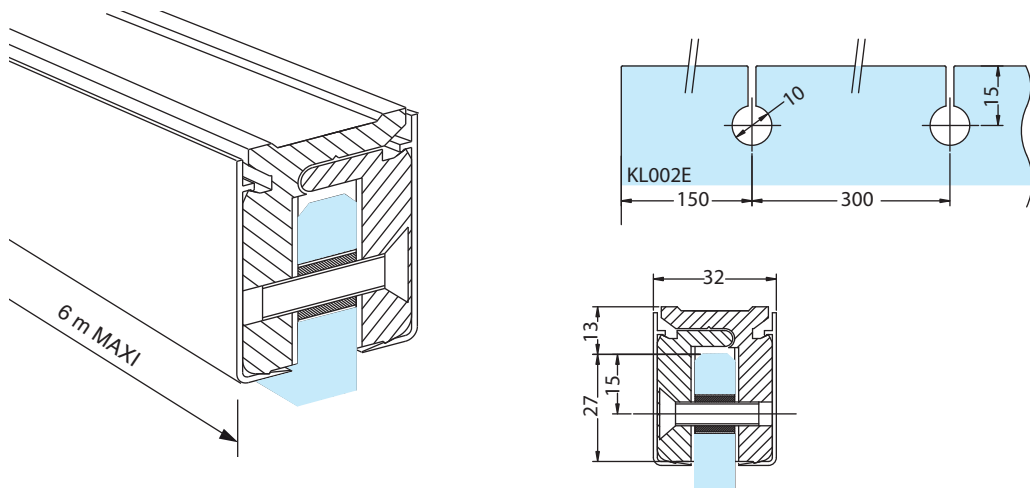

Verre suspendu poids maxi : 40 kg par mètre courant (le mètre)
Hanging glass maximum weight : 40 kg per running metre (per meter)

Références / References

EL 6000	40	Profil de serrage avec caches pour panneaux fixes avec trous (le mètre) <i>Glass clamp profile incl. covers for glass with holes notches (per meter)</i>	Aluminium anodisé Argent Brossé <i>Brushed anodised alu. silver</i>	Aluminium anodisé Aninox <i>Brushed anodised alu. aninox</i>
		Pour verre de 8 mm <i>For 8 mm glass</i>	KL002/08.12	KL002/08.36
		Pour verre de 10 mm <i>For 10 mm glass</i>	KL002/10.12	KL002/10.36

KL003

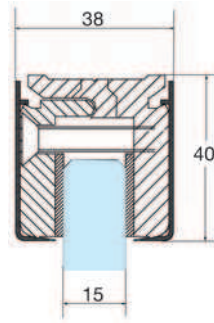
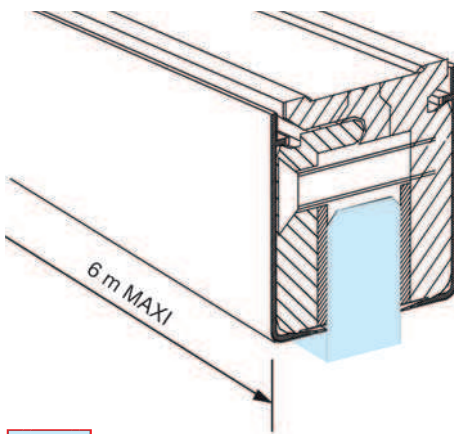

Verre suspendu poids maxi : 40 kg par mètre courant.
Hanging glass maximum weight : 40 kg per running metre

Références / References

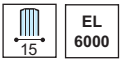

Aluminium anodisé Argent Brossé
Brushed anodised alu. silver



Aluminium anodisé Aninox
Brushed anodised alu. aninox

Profil de serrage pour panneaux fixes avec caches (le mètre)
Glass clamp profile incl. covers (per meter)

KL003.12

KL003.36

KL005

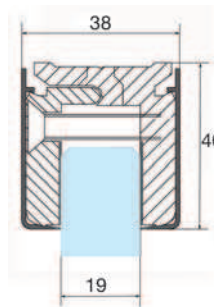
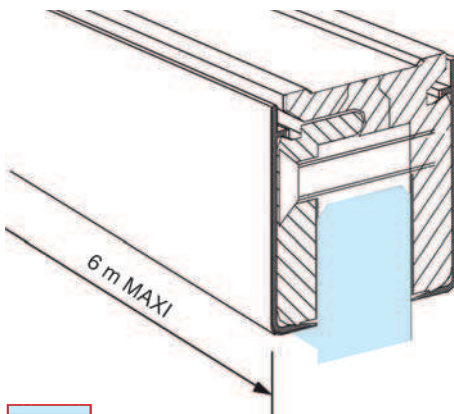

Verre suspendu poids maxi : 40 kg par mètre courant
Hanging glass maximum weight : 40 kg per running metre

Références / References

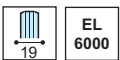

Aluminium anodisé Argent Brossé
Brushed anodised alu. silver



Aluminium anodisé Aninox
Brushed anodised alu. aninox

Profil de serrage pour panneaux fixes avec caches
Glass clamp profile incl. covers

KL005.12

KL005.36

KLA01

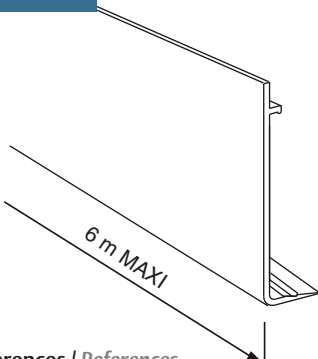

Références / References



Caches pour profil de serrage KL001 - KL002 - KL003 - KL005
Covers for glass clamp profile KL001 - KL002 - KL003 - KL005



Aluminium anodisé Argent Brossé
Brushed anodised alu. silver



Aluminium anodisé Aninox
Brushed anodised alu. aninox

KLA01.12

KLA01.36

KRAUS Glas Beschlaege, s. r .o.
Hrachová 14/C
821 05 Bratislava, Slovensko
Email: info@kraussro.sk
Tel.: + 421 2 2092 0888

ASSA ABLOY is the global leader in door opening solutions, dedicated to satisfying end-users needs for security, safety and convenience*

*ASSA ABLOY est le leader mondial des solutions d'accès destinées à répondre aux exigences de sécurité, de protection et de confort de l'utilisateur final

ASSA ABLOY GLASS

Services administratifs
rue Alexandre Fichet
80460 Oust-Marest - France
www.assaabloy.fr/glass

Administration des ventes (France)
Tél : +33(0)3 22 23 75 37
Tél : +33(0)3 22 23 75 40
Fax : +33(0)3 22 23 28 01

Sales administration (International)
Tél : +33(0)3 22 23 76 02
Tél : +33(0)3 22 23 76 12
Fax : +33(0)3 22 23 28 01

Relation Technique Clients
Tél : +33(0)1 39 46 11 88
support.glass@assaabloy.com

Customer technical support
Tél : +32(0)474 26 27 01
support.glass@assaabloy.com